

ZF Synchroma Gearbox S 5-325

Assembly, Maintenance and Operation

Contents

- I. Technical data
- II. Description
- III. Operation
- IV. Maintenance
- V. Tools
- VI. Dismounting and checking individual members
- VII. Assembly and operational check
- VIII. Ordering of spare parts
- IX. Key to illustrations and exploded view
- X. Service stations

I. Technical data

max. input torque: 44 mkg (317 ft.lb.)

Ratios:	1st speed	2.73
	2nd speed	1.76
	3rd speed	1.23
	4th speed	1.0
	5th speed	0.83
	reverse	3.31
	speedometer	1.75

1st to 5th gear synchro mesh; reverse with sliding gear

Weight of gearbox: approx. 56 kg (123 lb)

Oil capacity: approx. 2.0 litres (3.5 pints)

V. Tools

Tool .1. Bench cradle Tool No.

Tool .2. Bearing replacer for front taper roller bearing (307) on
layshaft. Tool No. 1248 898 051

Tool .3. Bearing replacer for rear taper roller bearing (304) on
layshaft. Tool No. 1248 898 052

Tool .4. Guide bush for synchronizer body (1st and 2nd gear).

Tool No. 1211 898 001

Tool .5. Replacer for roller bearing inner rings, bearing bush

(436), sleeve carrier (438) and speedometer worm (442)

on input shaft. Tool No. 1248 898 053

Tool .6. 2 distance pieces for protecting the synchronizer rings

during replacement of input shaft. Tool No. 1248 898 101

Tool .7. Remover (main tool used in conjunction with tools .10.

to .17. Tool No. 1248 898 201

Tool .8. Input shaft remover. Tool No. 1248 898 204

Tool .9. Yoke for removing clutch body from input shaft, when

latter is pulled out of the housing with tool .8. Tool

No. 1248 898 351

Tool .10. Adaptor set for removing speedometer worm (442). Tool

No. 1248 898 202

Tool .11. Adaptor set for removing the sleeve carrier (438). Tool

No. 1248 698 206

Tool .12. Adaptor set for removing the needle bearing rings (436).

Tool No, 1248 898 906

Tool .13. Adaptor set for removing 1st speed gear (424) from main

shaft. Tool No. 1248 898 207.

Tool 14,. Thread protector for main shaft (414). Tool No. 1248 898

054

Tool .15. Adaptor set for removing the rear taper roller bearing

(304) from the layshaft. (305). Tool No. 1248 898 209

Tool .16. Adaptor set for removing the front taper roller bearing

(307) from the layshaft. Tool No. 1248 896 208

Tool .17. Adaptor set for removing the helical gear 5th speed

(302) from the layshaft. Tool No, 1248 898 205

Tool .18. Remover for reverse shaft (503). Tool No, 1248 898 206

VI. Dismantling

Fig. 1

1. Removal of gearshift mechanism

Place gearbox into bench cradle .1. and push selector forks into neutral.

After unscrewing bolts (704) remove gearbox cover (707) from housing. (Fig. 1).

Unscrew 2 swivel bolts (116) and remove 5th gear selector fork (634).

Fig. 2.

2. Removal of main shaft and input shaft

After loosening screw (809) remove speedometer drive. Engage two gears, remove tab washer (444) on output flange (443) and hexagon screw (445) and withdraw flange.

Unscrew hexagon bolts (109 and 112) and nuts (105) of end housing (111). (Fig. 2). Remove one of the two set screws (107) so that the housing can be shifted slightly and then removed.

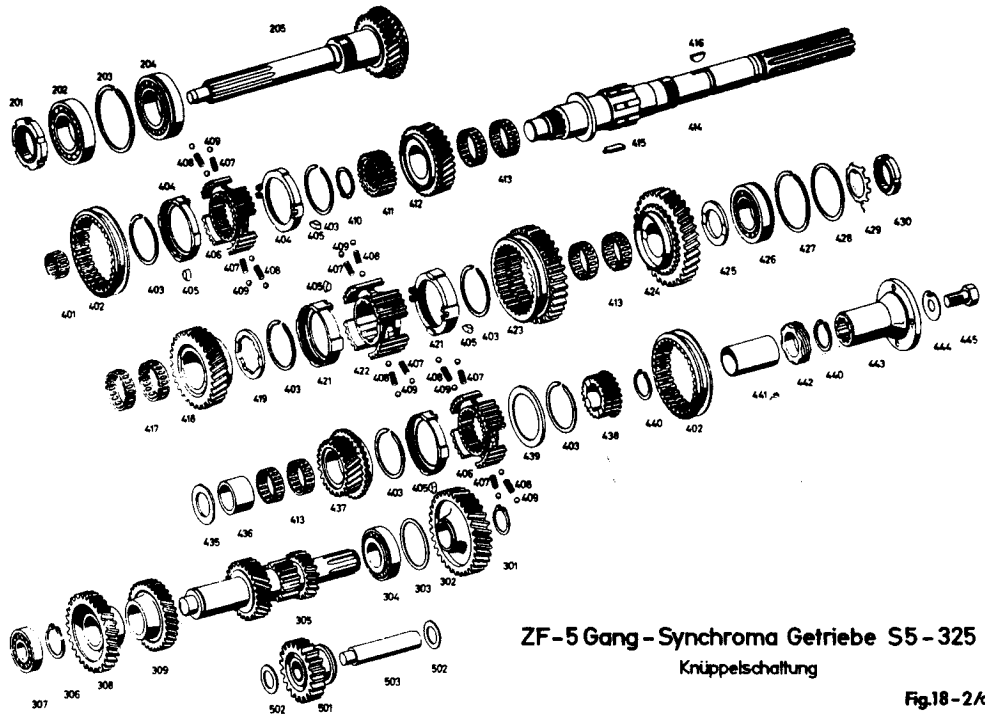
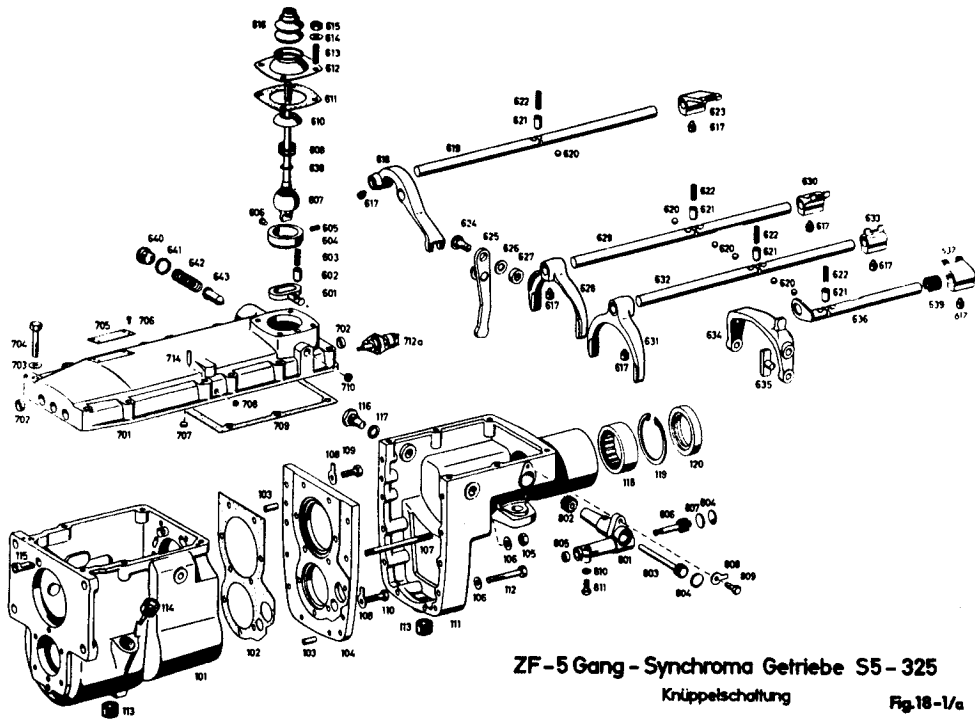

Fig. 3.

Release circlip (440) and remove speedometer worm (442) from output shaft, using tool .7. and adaptor set 9109 (Fig. 3).

Release second circlip (440).

Fig. 4.

Remove distance bush (441) and release third circlip (440) on 5th speed gear. Using main tool .7. and adaptor set .11., withdraw complete 5th speed gear synchronizer body (406), placing remover on sleeve carrier (438) (Fig. 4). Remove main shaft key (416) and withdraw 5th speed gear (437) together with needle cage (413).

Fig. 5.

Withdraw bearing bush (436) from shaft, using main tool .7. and adaptor set .12. (Fig. 5) and remove, thrust washer (435).

Fig. 6.

Release circlip (301) and withdraw 5th speed layshaft gear(302), using main tool .7. and adaptor set .17. Loosen screws (110) and

remove Intermediate plate (104). Unbend looking piece(429), engage two gears and unscrew look nut (430) with a commercial hook spanner. (Fig. 6). Remove look nut (201) on input shaft (205) in the same manner.

Fig. 7.

Put sliding sleeves into neutral and place tool .9. between housing wall and 4th speed clutch body (on input shaft). Withdraw Input shaft with the aid of tool .8. (Fig. 7). Press bell bearing (202) and roller bearing (204) from input shaft and remove needle bearing (401) from end of main shaft. Using a rubber hammer, drive the main shaft with light blows 2 - 3 mm towards the input side and remove the ball bearing (426)

Fig. 8.

Lift the main shaft and all its components with input side first, in a slanting position out of the housing (Fig. 8).

Fig. 9.

Fig. 10.

3. Removal of layshaft and reverse

With a soft drift drive the layshaft towards the rear until roller bearing (304) on input side is free of the housing. Remove inner ring of roller bearing (304) with main tool .7. and adaptor set .15. (Fig. 9). Take the layshaft, with the large gear wheel first, out of the gearbox housing (Fig. 10). Remove front roller bearing (307) from the shaft, using main tool .7. and adaptor set .16. (Fig. 11). Release circlip (306). Withdraw reverse shaft (503) with tool .18. and remove reverse gear (501) and thrust washer (502).

Fig, 11.

Fig. 12.

4. Dismantling the main shaft

Clamp main shaft at splined section vertical in a vice with soft

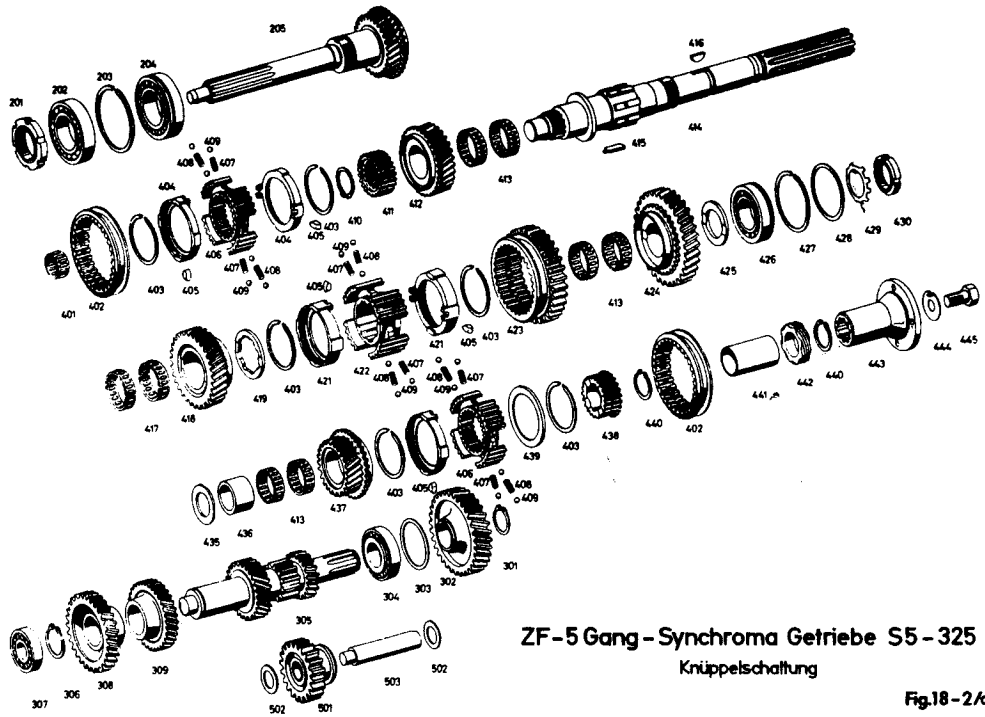
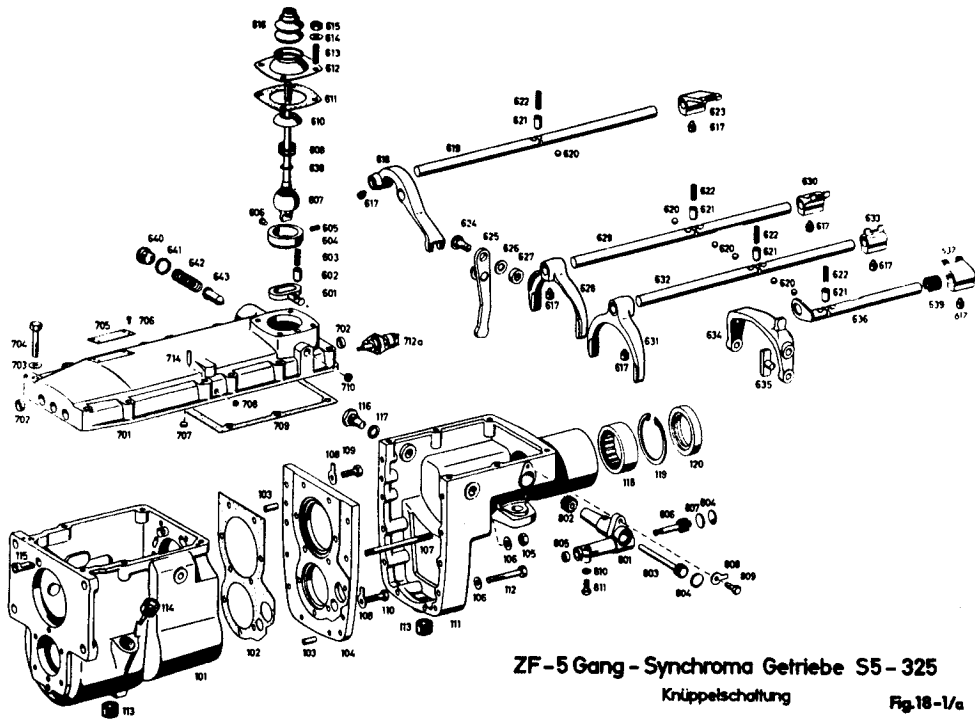

jaws. Release circlip (410) on sleeve carrier. Remove sliding sleeve (402) together with synchronizer components and sleeve carrier (411). Withdraw 3rd speed gear (412) (Fig. 12) and both needle bearings (413) from shaft. Take main shaft out of vice.

Fig. 13

Remove 1st speed gear (424), using tool .7. together with adaptor set .13. and thread protector .14. (Fig. 13). Lift the 2 needle cages (413) over the splined section and remove reverse spur gear (423) together with the synchronizer components, taking care not to lose the key (415).

Remove 2nd speed gear (418) and split needle bearing (417).

Fig. 14.

5. Disassemble the synchronizer components.

Press spur gear (423) respectively sliding sleeve (402) from synchronizer body (422) or (406), taking care not to lose the 6 balls (409) and the 4 springs (497 and 408), which are liable

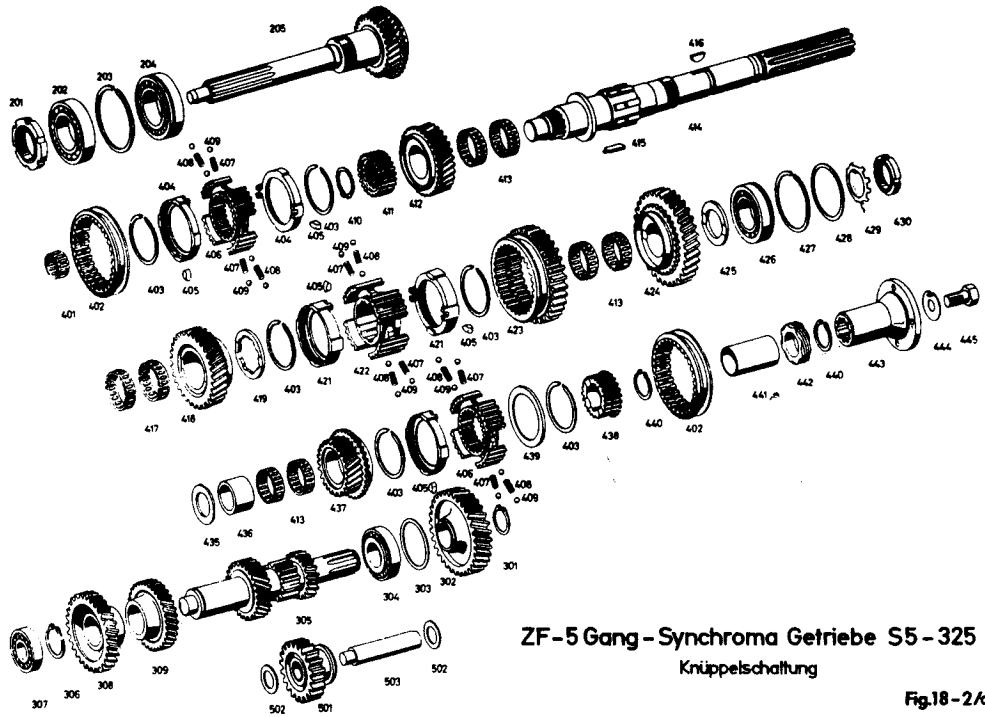
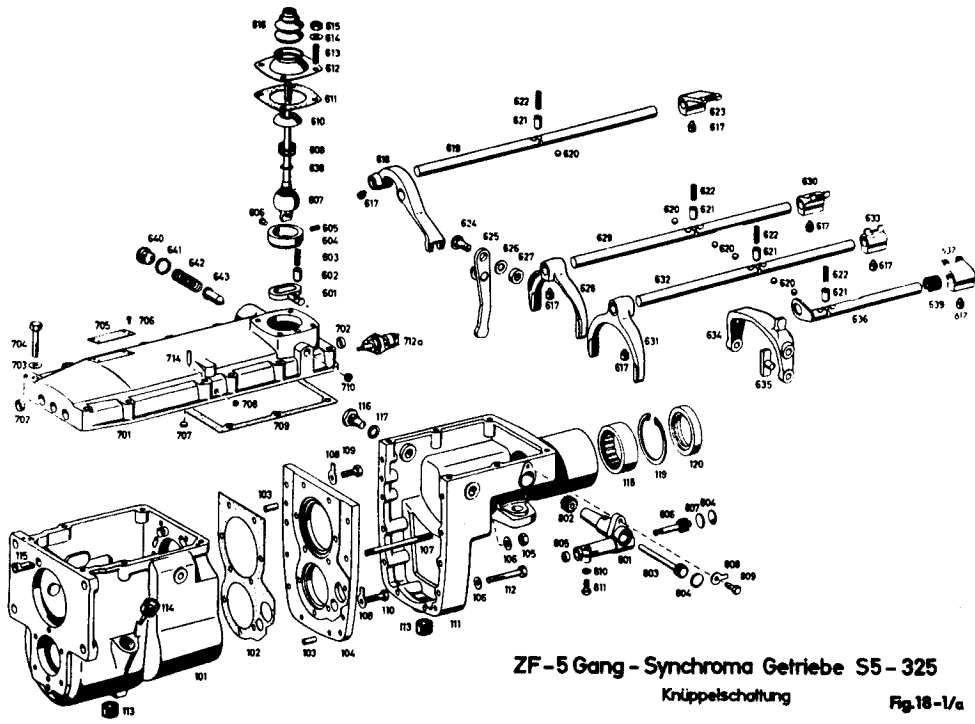

to jump out. It would be advisable to cover these components with a cloth, so that they cannot get lost.

Release circlips (403) and remove synchronizer rings (404 and 421) and the locking Pawls (405) (Fig. 14).

Fig. 15.

6. Dismantling cover and gearshift mechanism

Unscrew hexagon nuts (615) and remove selector tower (612) and selector lever (607). Remove reversing light switch. Remove all cover plates (702). Loosen all grub screws (617) on the selector forks and drivers (Fig. 15) and knock out the selector bars from the rear (selector tower).

Remove detent pins (621), compression springs (622) and balls (620). Remove slide bars (601), detent pins (602) and compression springs (603) from housing cover.

Remove shaft seal (120), circlip (119) and needle bearing (118) from end housing (111) and take all seal rings and shims out of

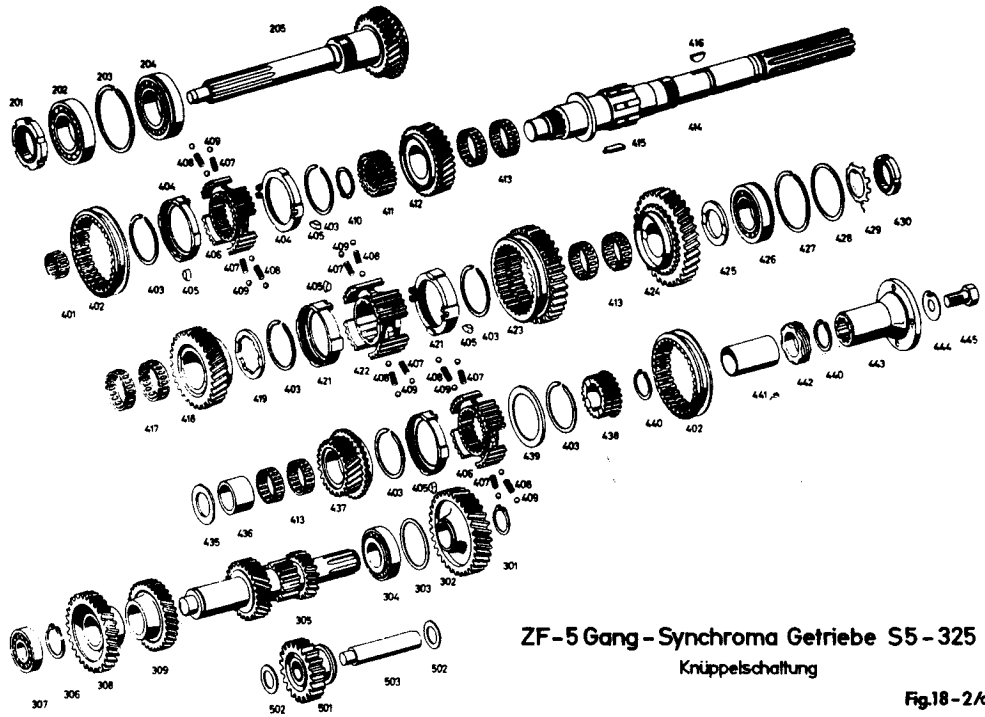
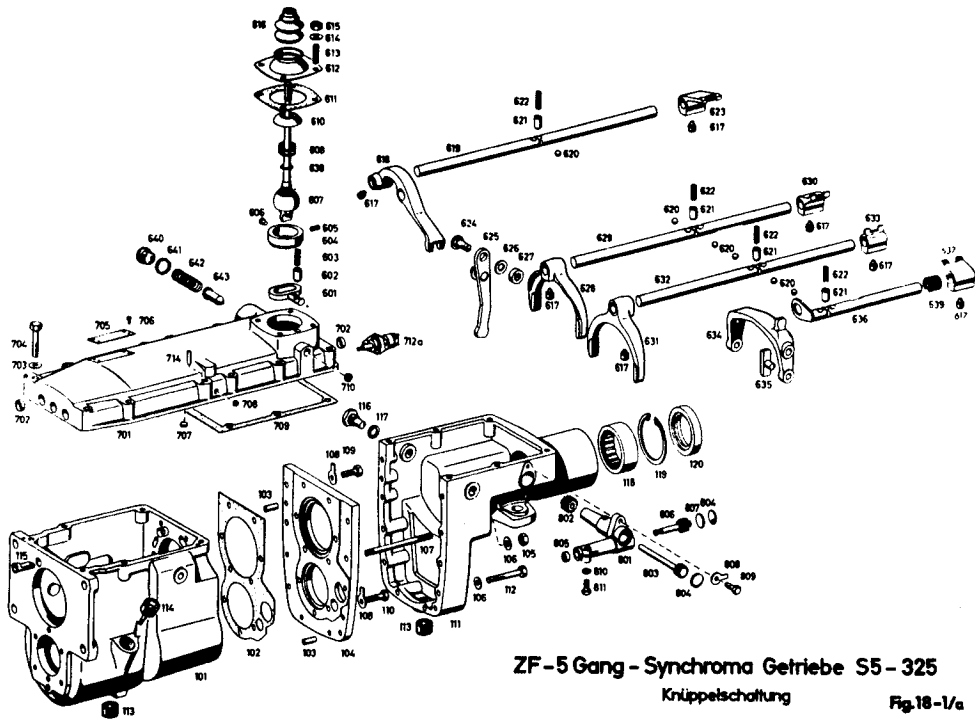

housing and cover.

Checking the individual components

Test synchronizer rings (404 and 421) for wear. If the rings are worn, they must be exchanged for new ones.

Test teeth of clutch body for wear and damage. All selector forks must be tested for wear, if bent they should be renewed and not straightened out. Test locking pawls, stop bolts, balls and selector bar (635) for wear. Test ball and roller bearings for wear.

The contact surfaces of the needle bearings and the needles themselves should not show any signs of wear, Input shaft and clutch body can only be exchanged as a complete unit as the clutch body is ground when mounted on the shaft. Input shaft and clutch body are each punch-marked.

Check output flange (443) for running-in defects of the shaft seal (120) and the needle bearing (118).

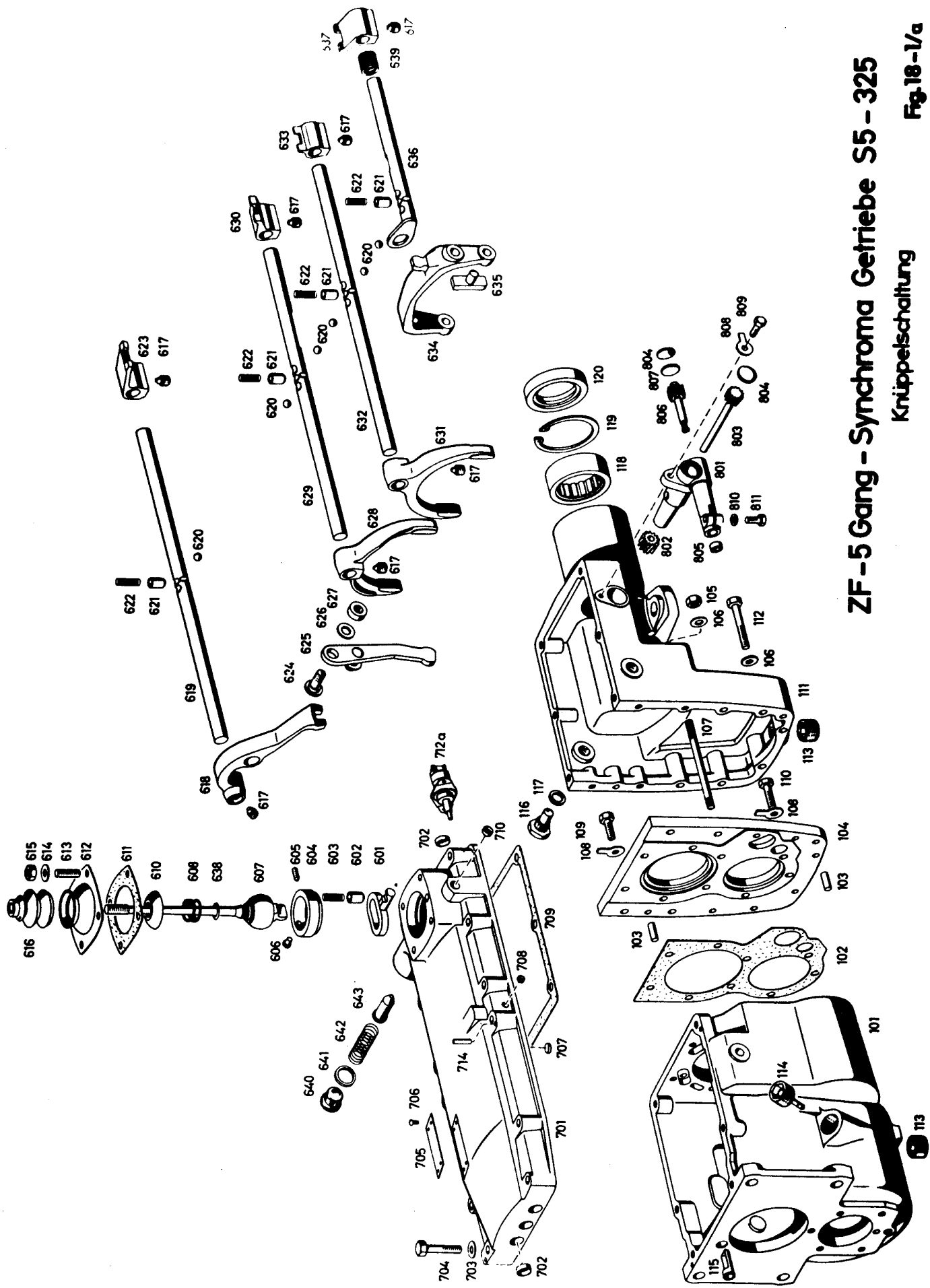

ZF-5 Gang - Synchroma Getriebe S5 - 325

Knüppelschaltung

Fig.16-1/a

If the housing, intermediate plate, or end housing have been damaged due to improper handling, they must be exchanged jointly.

VII. Assembly of the gearbox S 5-325

All components must be thoroughly cleaned before the gearbox is assembled. Any residues of paint on the joint faces of housing and cover must always be removed. Each component must be tested for wear or other defects and must be well greased before they are assembled. Seal rings, joints and tab washers must be renewed. Special care should be taken that no chips or other foreign matter remain inside the housing.

Always use a soft hammer (rubber, plastic, etc.), for driving home shafts and bolts; never use a steel hammer direct on gearbox components.

Assemble the individual shafts and the complete gearbox in

reverse order to the dismantling instructions, Gear wheels with collars on one side must be correctly positioned during the assembly.

A. Assembly of reverse

Clamp gearbox into bench cradle .1.

Drive the reverse shaft (503), with small diameter first, into the bore of the housing (101) until thrust washer (502) and the reverse gear (501) can be mounted. The groove for the selector fork on the reverse shaft must point towards output side. Place second thrust washer in position and drive the reverse shaft into the housing (Fig. 16). Make sure that the milled face of the reverse shaft is in oorrect position so that the intermediate Plate (104) can be flanged to the housing.

Fig. 16.

B. Assembly and installation of layshaft

Insert circlip (306) and press the small roller bearing (307) on input end of layshaft (305), using bearing replacer .2. (Fig. 17).

Guide layshaft with input end first, in a slanting position into the housing (Fig. 10). With the aid of bearing replacer .3. press the rear roller bearing (304) on the shaft (Fig. 18). Drive outer bearing rings of front and rear roller bearings into the housing, using a soft hammer.

Fig. 17.

Fig. 18.

C. Pre-assemble synchronizer

Fig. 19.

- a) 3rd and 4th gear synchronizer body
1. Place synchronizer rings (404), offset against each other by 90° on the synchronizer body and place circlips (403) in position. Make sure that the synchronizer rings can turn easily. The position of synchronizer rings to synchronizer body is optional.

Place the 4 locking pawls (405) into the recesses of the

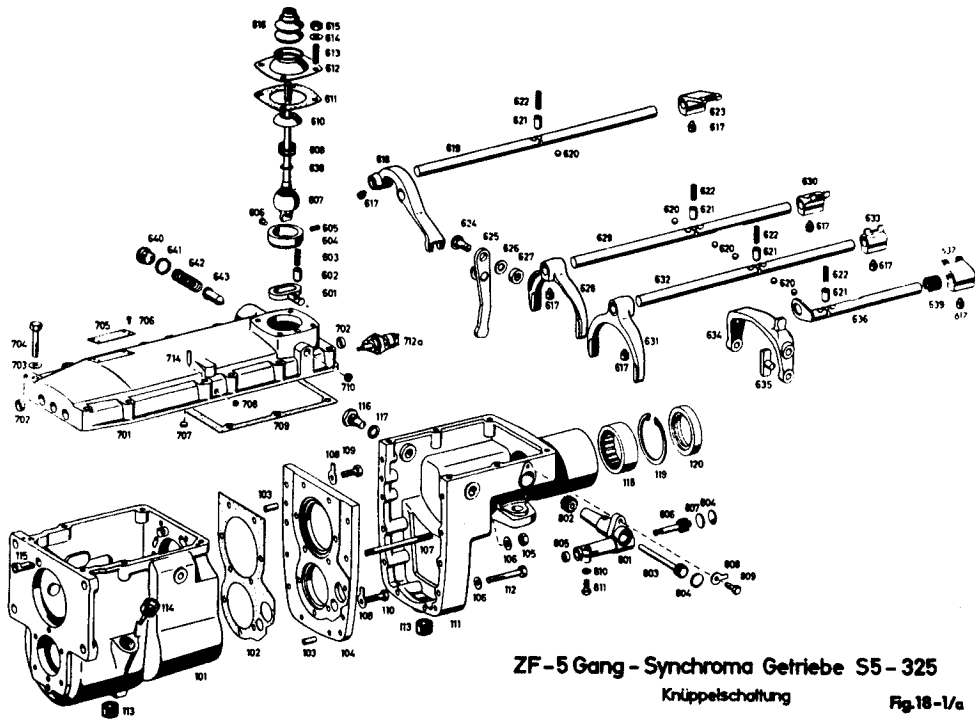

ZF-5 Gang - Synchroma Getriebe S5 - 325

Knüppelschaltung

Fig.18-1/a

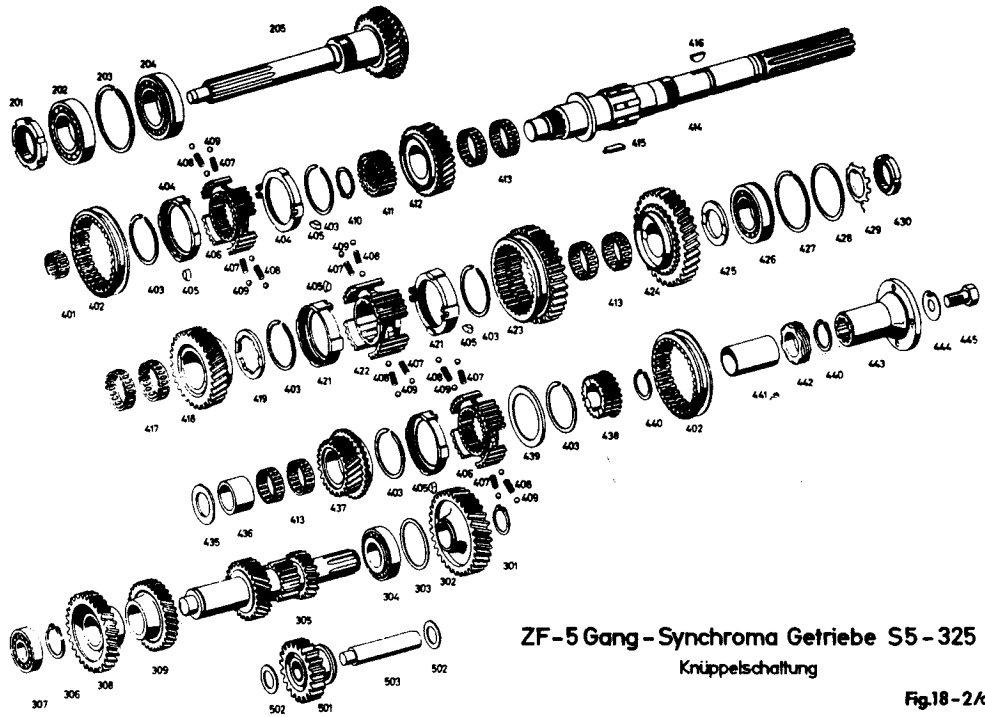

ZF-5 Gang - Synchroma Getriebe S5 - 325

Knüppelschaltung

Fig.18-2/a

synchronizer rings so that the inner conical point of the pawl points towards the centre of the synchronizer body (Fig. 19).

Fig. 20.

2. Place the two longer compression springs (407) into the blind holes of the synchronizer body and attach one ball (400) with some grease to each compression spring. Before the sliding sleeve (402) is mounted the following points must receive consideration:

Four times two adjacent tooth of the sliding sleeve are designed as locking teeth, which during the synchronizing process press the pawls upwards. The sliding sleeve must be placed over the pre-assembled synchronizer body so that one pawl will always lie between the two locking teeth. (Fig. 20).

Moreover, the looking teeth must lie behind the pawl; as

viewed when the pre-assembled synchronizer body is lying in a horizontal position on a plate.

The 2 pawls, which are enclosed, respectively carried along by the upper synchronizer ring, must lie above the locking teeth. (Locking teeth therefore in lower half of sliding sleeve).

The two other pawls, which are carried along by the lower synchronizer ring, lie below the locking teeth. (Locking teeth therefore in upper half of sliding sleeve).

It is also most important that the teeth of the sliding sleeve, which are chamfered at both ends, always lie over the balls, in order to prevent the balls from binding when the gears are disengaged. When the sliding sleeve has been mounted incorrectly (upside down), the chamfered teeth are lying next to the balls and not over the balls.

3. From the inside, place into each of the 2 through bores of

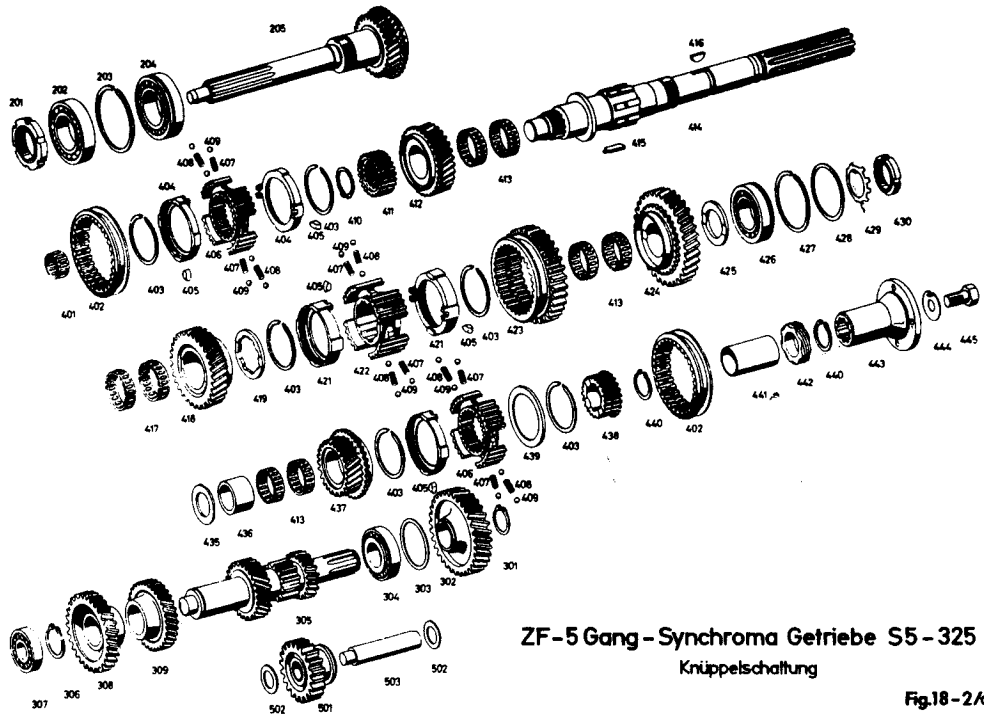
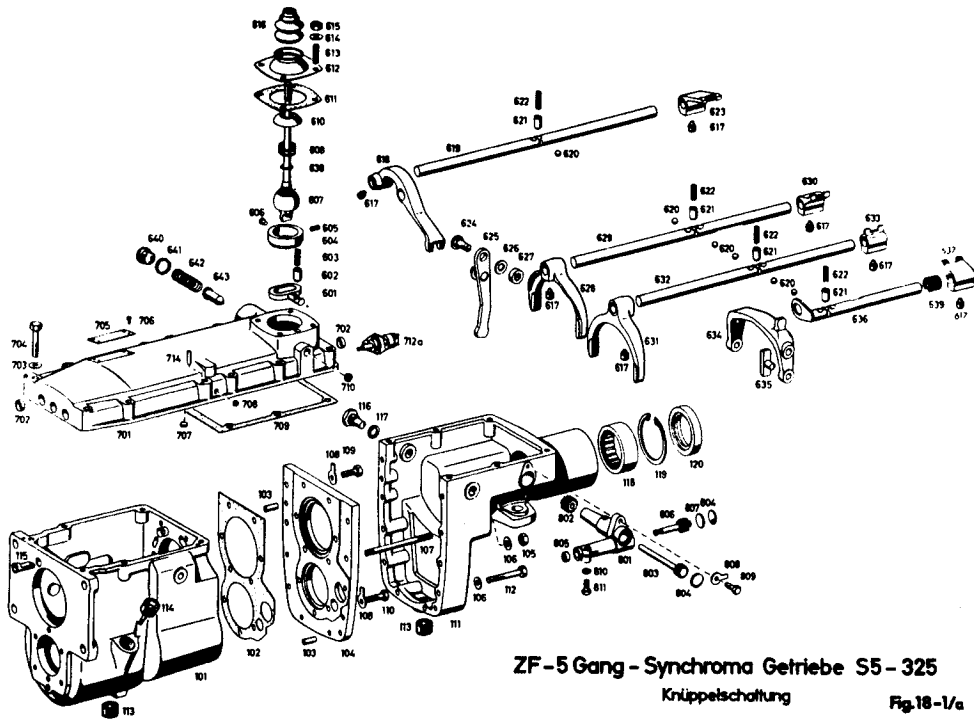

the synchronizer body one ball (409), one compression spring (408) (these are 0.7 mm shorter than those in the blind holes) and then attach another ball with some grease. Push sleeve carrier (411) into the bore of the synchronizer body, taking care that the two balls are pressed into the bore.

b) 1st and 2nd gear synchronizer body

The synchronizer for the 1st and 2nd gear is assembled as described above, with the exception that in place of the sliding sleeve (402) the spur gear (423) is pushed over the synchronizer body (422). A sleeve carrier is not necessary as the synchronizer body is placed direct on the main shaft (414).

c) The 5th gear synchronizer is only required to operate in one direction, its design, however, is similar to the 3rd and 4th gear synchronizer.

The stops of the sleeve carrier (438), which is used with this synchronizer must rest against the synchronizer body on the

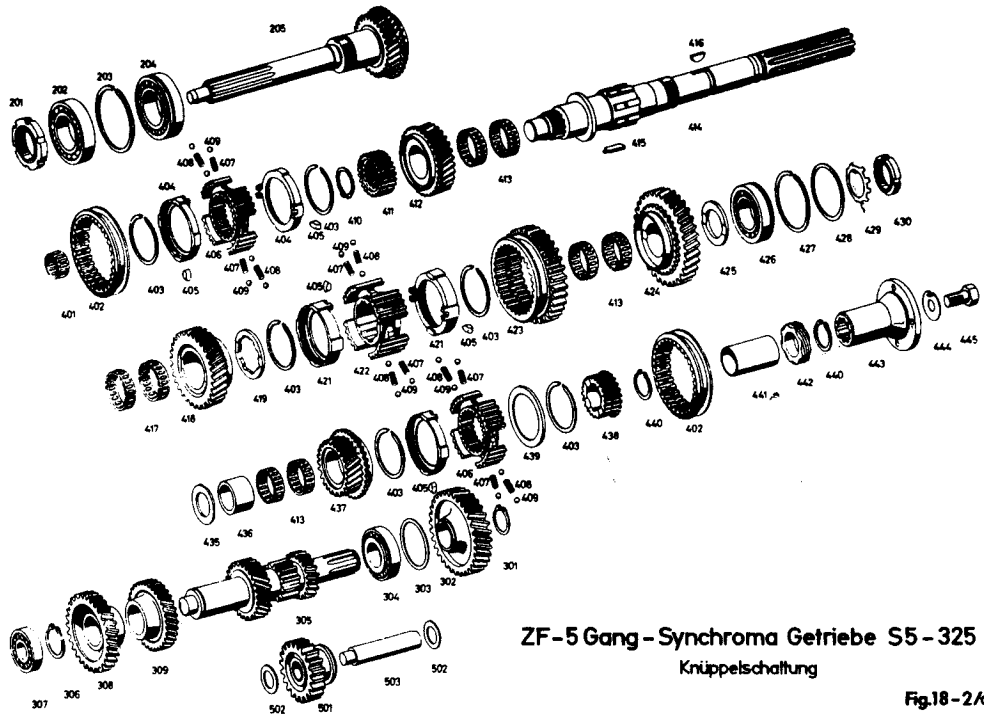
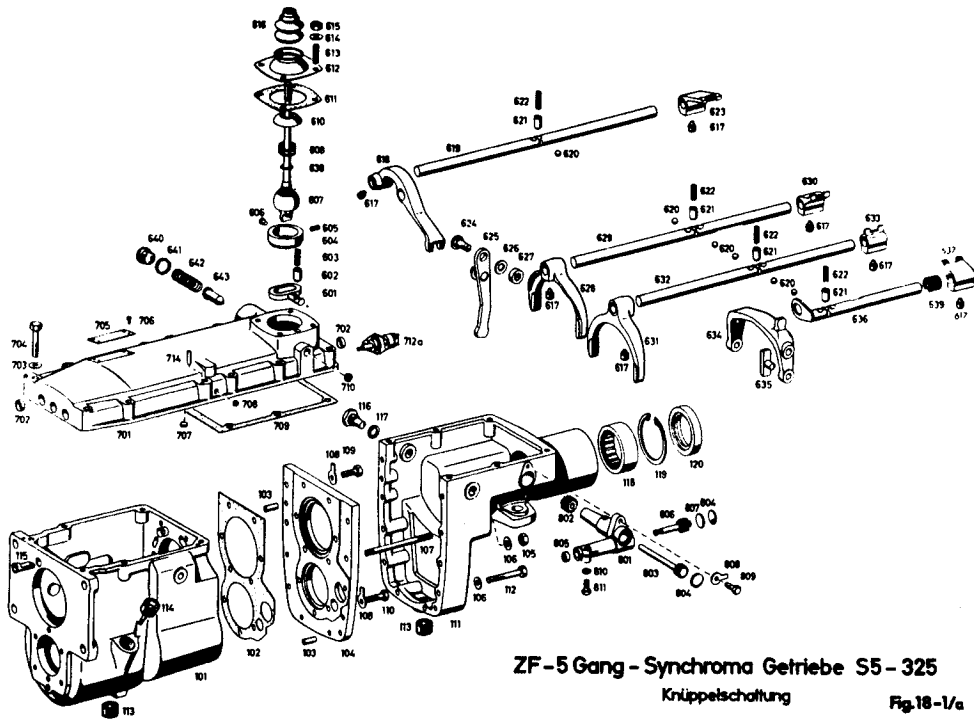

opposite side of the synchronizer ring (404) when the sleeve carrier is placed in position. In place of the second synchronizer ring a disc (439) is used, and this is secured with a circlip (403).

D. Assembly of main shaft

Fig. 21

Clamp main shaft (414), with long splines pointing upwards, in a vice. (Use lead jaws).

Secure the two special split bearings (417) with some grease to the sliding surface of the shaft (above collar). Push the 2nd speed spur gear (417) over the two split bearings so that the conical end points towards output side (facing upwards).

Place thrust washer (419) on helical gear so that the two oil grooves are facing downwards. (Fig. 21).

Fig. 22

Turn the thrust washer so that the milled slot on one of the internal splines of the thrust washer is in line with the keyway

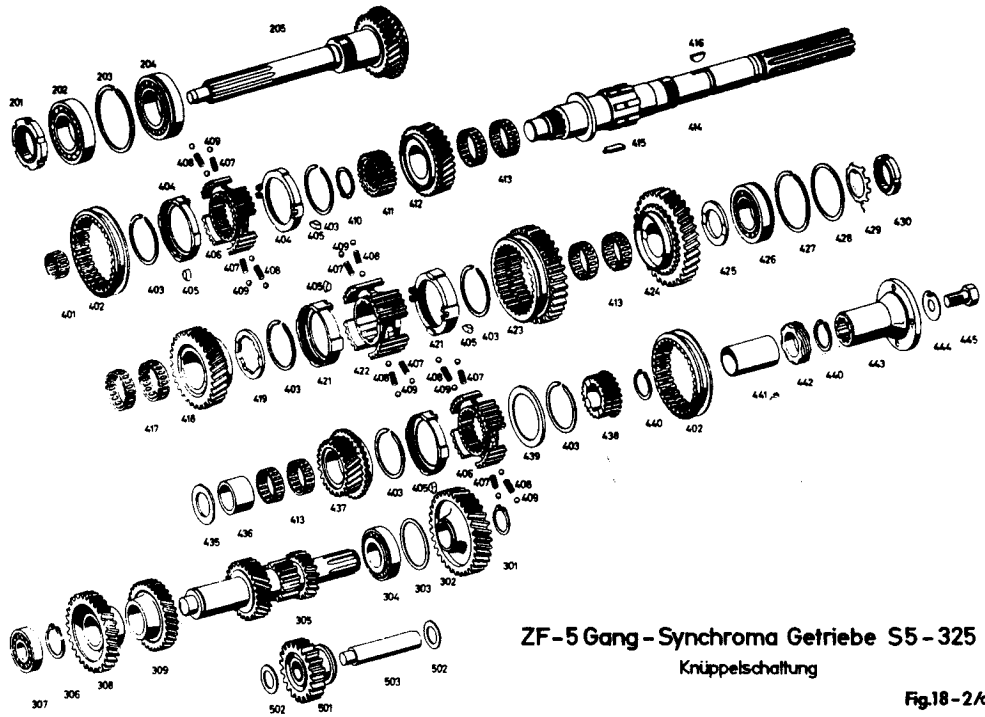
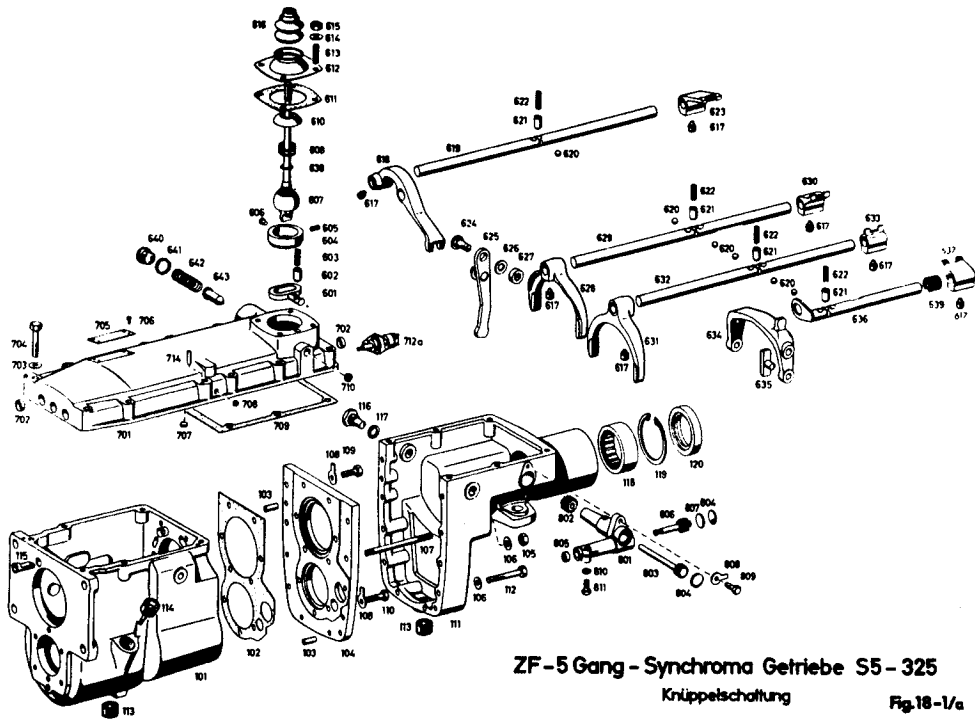

on one of the main shaft splines. Place the key with some grease into the keyway of the shaft spline as shown in Fig. 22. The small end of the key must fit into the recess cut into the thrust washer (419).

Fig. 23.

Place pre-assembled 1st and 2nd gear synchronizer and spur gear on the main shaft, using guide bush .4. (Fig. 23). This guide bush presses the inner balls (409) previously placed in the through bores of the synchronizer body outwards. Under no circumstances should the balls rest against the shaft key (415). Gear teeth of spur gear must face upwards, towards output side. Mount the 2 needle bearings (413) and the 1st speed gear (conical surface towards synchronizer). Place thrust washer (425) with oil grooves on the gear. Using bearing replacer .5. press one half of the bearing inner ring (ball bearing 426) on the main shaft. Clamp main shaft in a vice so that the long splines face downwards.

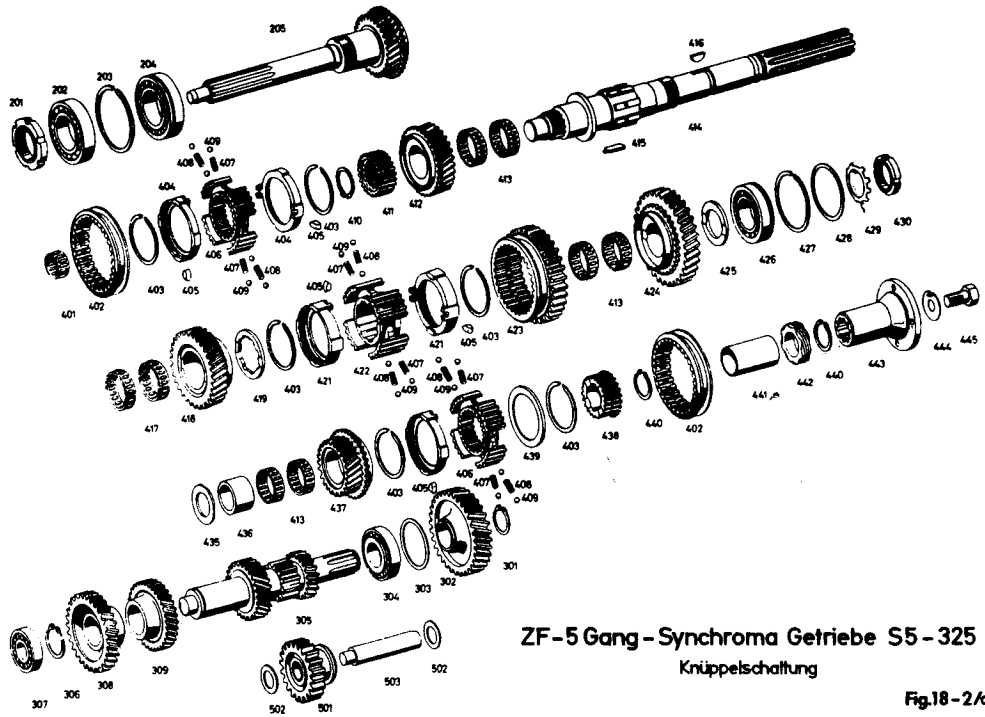
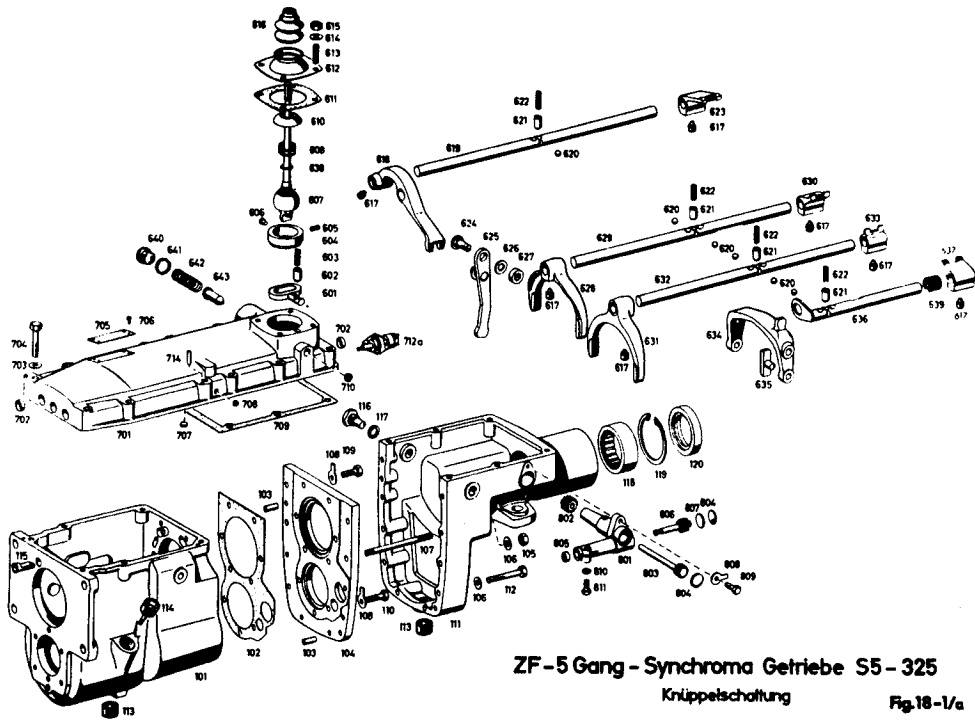

Mount 2 needle cages (413) and 3rd speed gear (412) with cone towards input side. Press pre-assembled 3rd and 4th gear synchronizer on shaft so that inner recess of the sleeve carrier (411) face upwards. (Fig. 24).

Place circlip (410) in position.

Check synchronizer clearance of 1st to 5th gear with feeler gauge.

The clearance should be 0.6 - 1 mm. If the clearance is too great a new synchronizer ring (404 or 421) must be installed; if the clearance is too fine, the synchronizer ring must be machined accordingly.

Engage 3rd speed gear.

Fig. 24

E. Installation of main shaft

The marked position of input shaft and clutch body must also be clearly marked on the outer teeth.

Place clutch body with cone end into the 4th gear synchronizer ring.

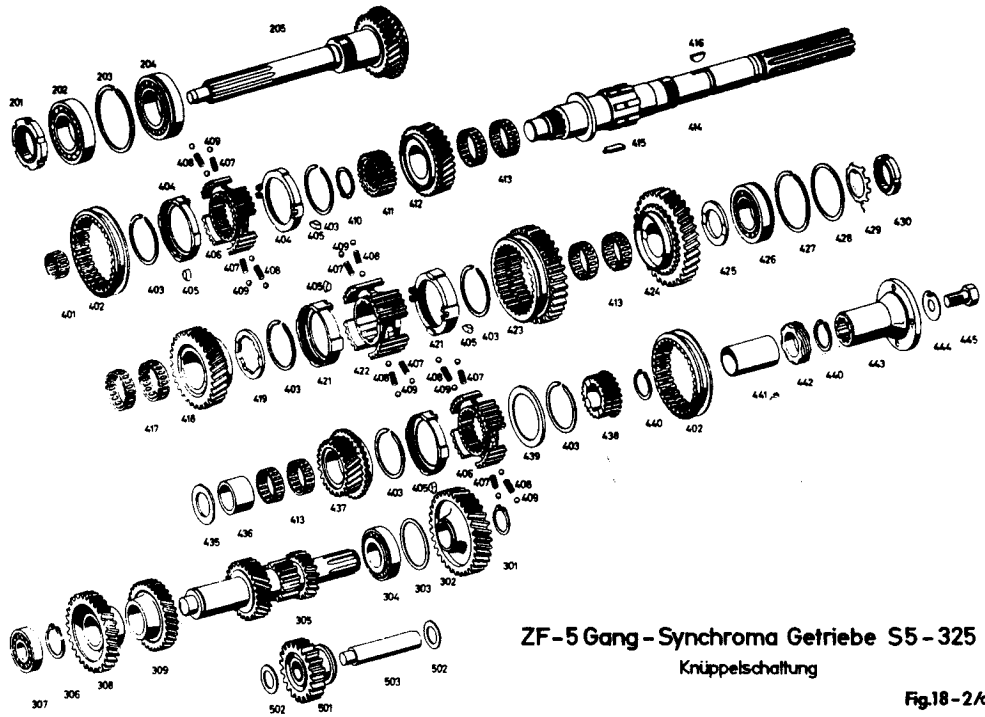
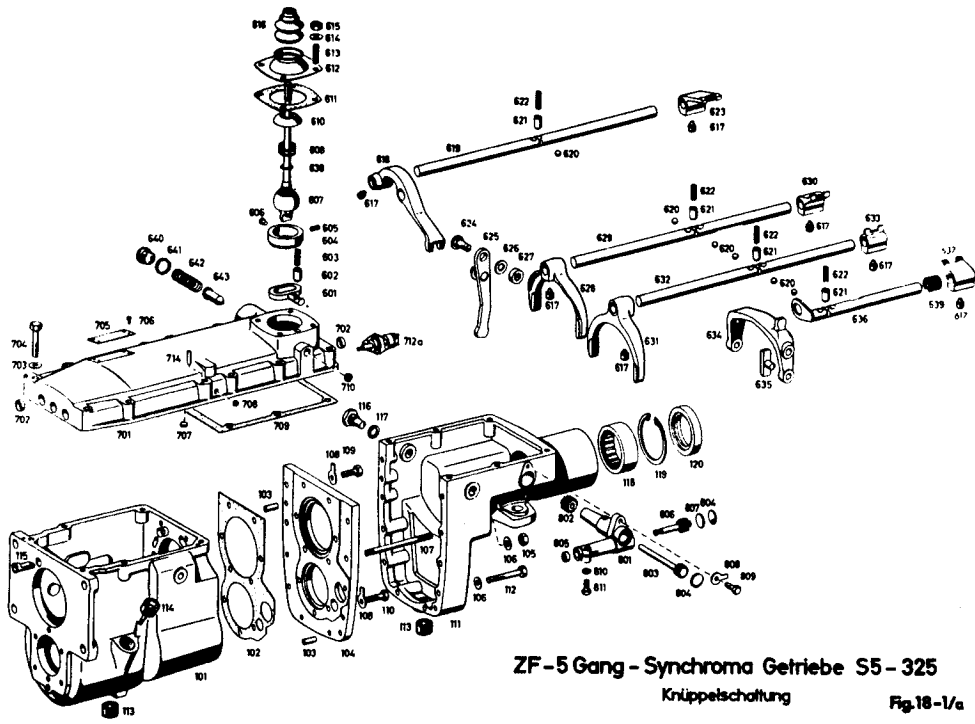

Guide the pre-assembled main shaft in a slanting position and with the output side first into the housing. (Fig. 8). (Fig 25). Press ball bearing (426) together with circlip into the housing and then press the second half of the bearing inner ring on the shaft, using bearing replacer .5. Mount locking ring (429) and tighten lock nut (430) with lock nut key. (Engage two gears). Secure lock nut.

F. Mount input shaft

Place circlip (203) into the radial groove of roller bearing (204).

Press first the roller bearing and then the ball bearing (202) on the input shaft (205).

Screw on lock nut (201). Place needle bearing (401) on end of main shaft and push the input shaft through the housing bore.

In order to protect the synchronizer rings (404), place one distance piece .6. in front and the other behind the sliding

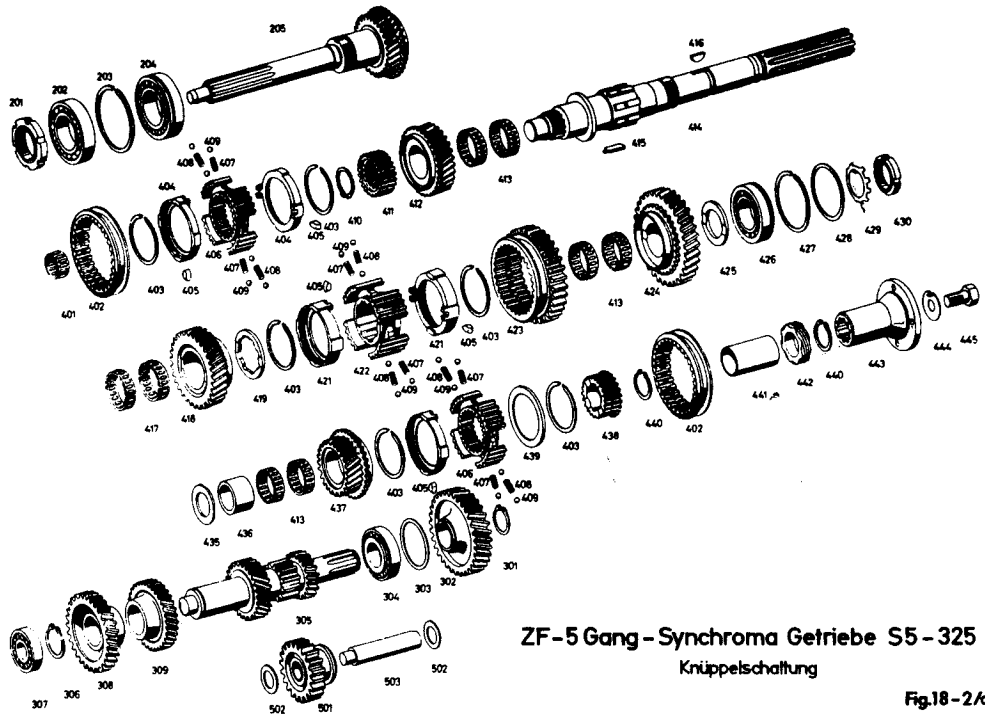
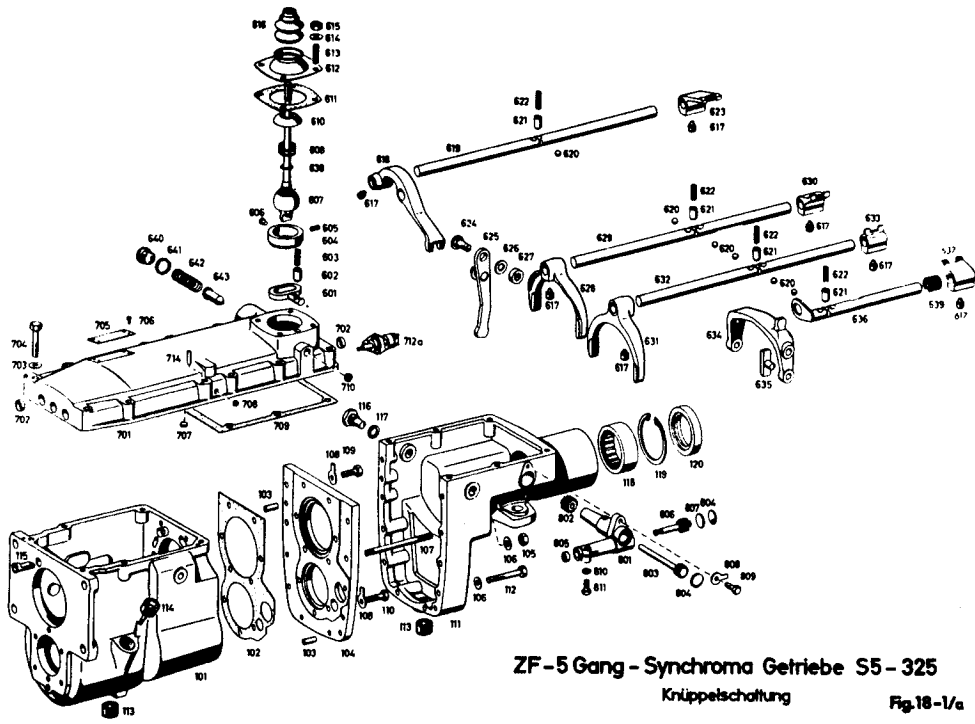

sleeve. (Fig 26).

Fig. 26.

With the aid of a soft hammer drive the input shaft according to the position markings into the internal teth of the clutch body.

Tighten lock nut (201) with commercial lock nut spanner and secure by driving the locking ring into the longitudinal groove of the input shaft.

Push oil collector pipe (115) from input side into the housing bore. (The open side of the bisected pipe points upwards and inside).

G. Mount Intermediate Plate

Fig. 27.

Drive the layshaft towards input side until the front bearing (307) is flush with the joint face of the housing. Push home outer ring of rear roller bearing (304).

Measure distance from outer ring of rear bearing to joint face

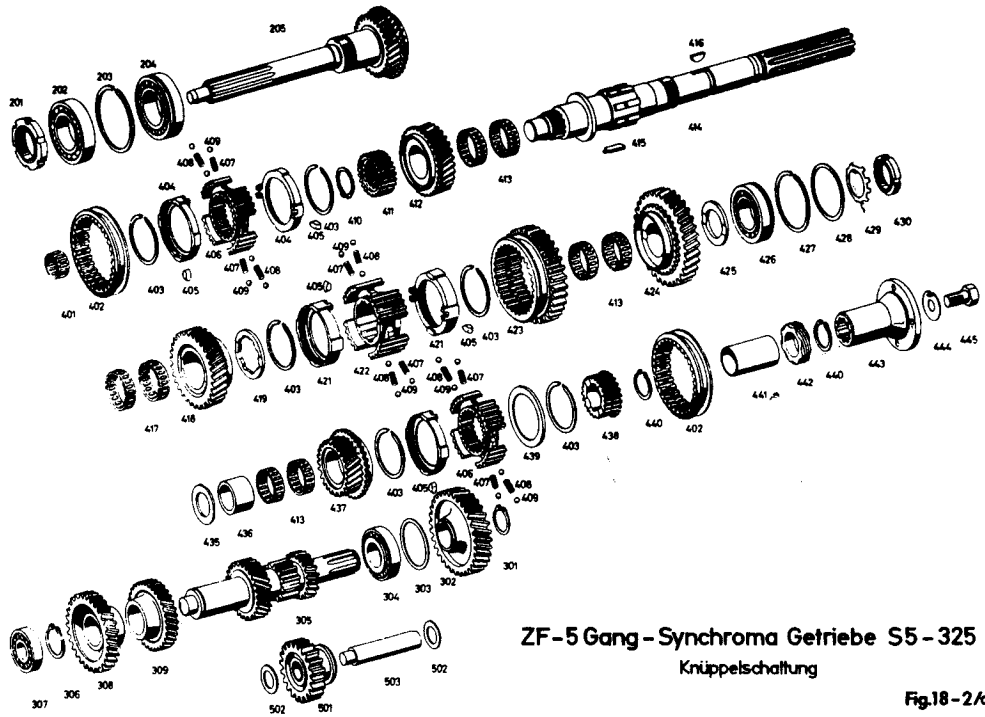
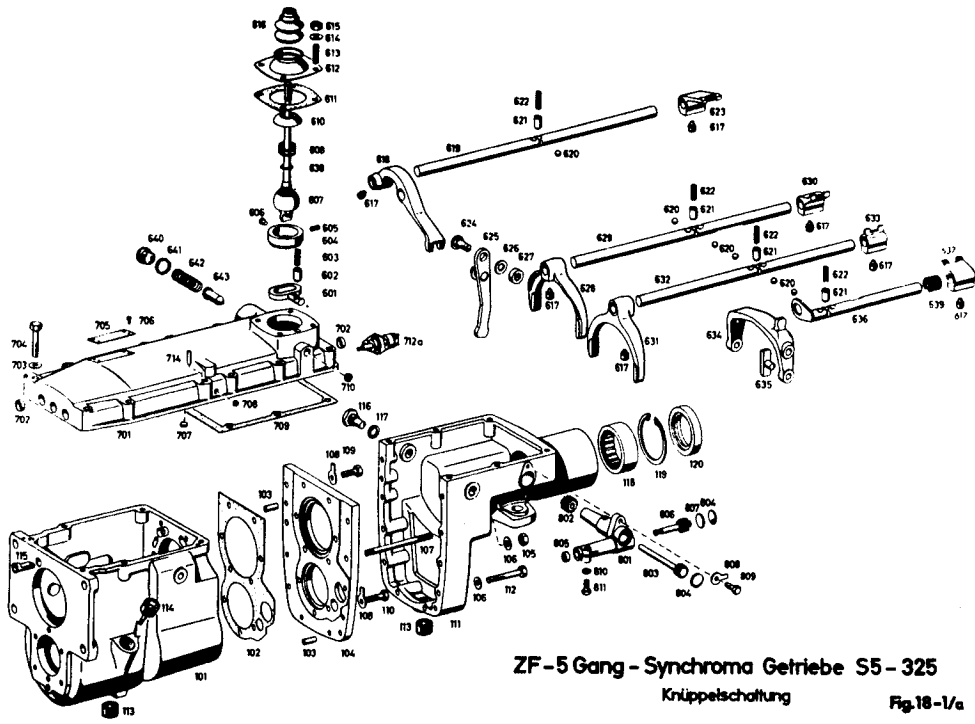

of housing, and also measure the depth of the respective recess in the intermediate plate (104). For this purpose the joint (102) must be placed on the intermediate plate. The difference between both measurements plus the initial stress of 0.03 - 0.05 mm will be the thickness of the shims (303) which are placed in the recess of the intermediate plate). The shims are available in sizes 0.05, 0.1, 0.2, 0.5 and 1.0 mm.

Fig. 28.

Push ball bearing (426) into the housing until the circlip (427) abuts. Determine thickness of shims (428) in a similar manner as for the roller bearing of the layshaft. Since in this case the distance of a ball bearing has to be adjusted, the initial stress of 0.03 - 0.05 mm is omitted. (Figs. 27 and 28).

The shims are also placed in the recess of the intermediate plate. They are available in sizes 0.1 and 0.15 mm. Again check 4th gear synchronizer clearance and if necessary adjust. Attach Joint (102)

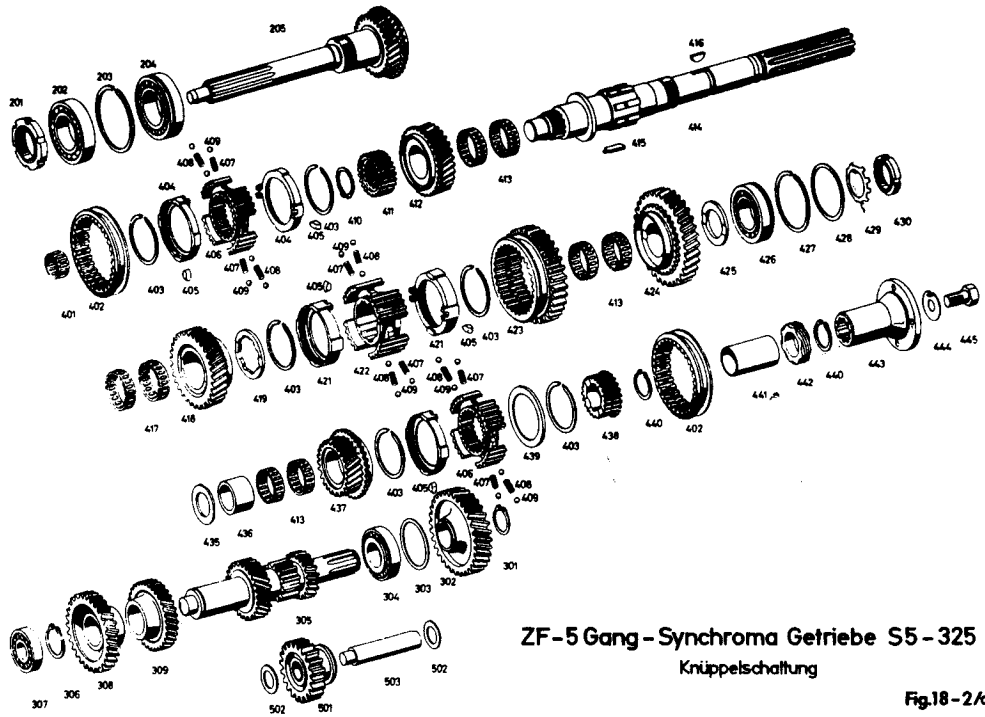
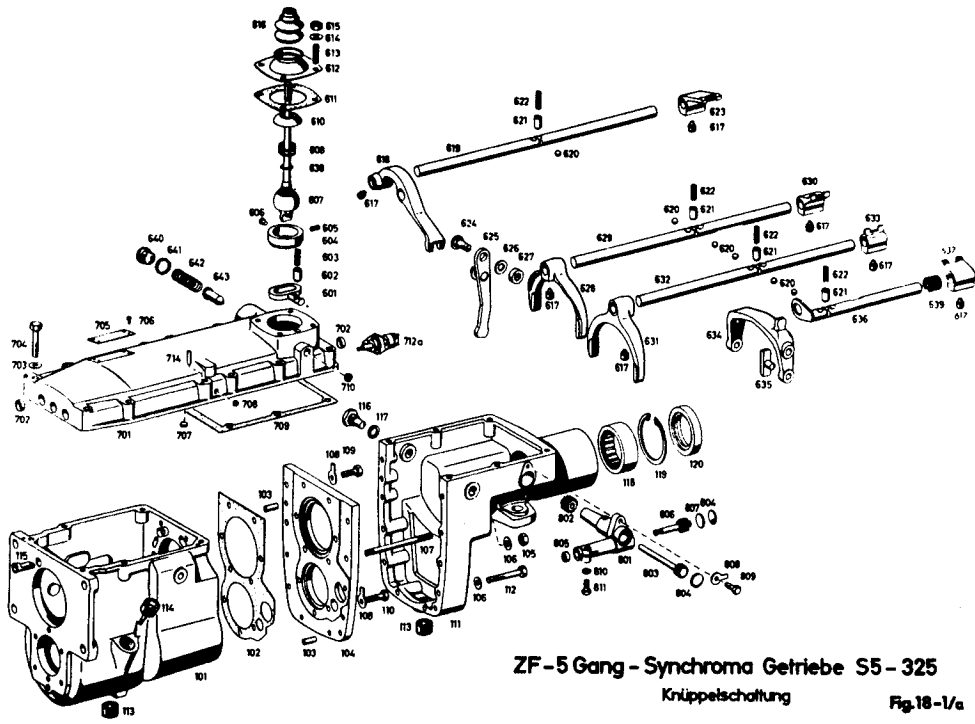

with some grease to the intermediate plate. Place intermediate plate with the inserted shims on the gearbox housing, tighten the 8 screws (110) and secure with tab washers (108). Knock set pins (103), which are used for centering the end housing, into the bores of the intermediate plate.

H. Mount 5th speed gear

Fig. 29.

Press the layshaft gear (302), with the cylindrical recess first, on the shaft, (Fig. 29) and insert circlip (301).

Fig. 30.

Place thrust washer (435), with oil grooves towards output side, against lock nut (430) and press bush (436) on the main shaft, using tool .5. Slide needle bearing (413) and 5th speed helical gear (437) over bush (436) so that the conical rim faces towards the output side. With the aid of a soft hammer drive two Woodruff keys (416) into the main shaft. Mount pre-assembled

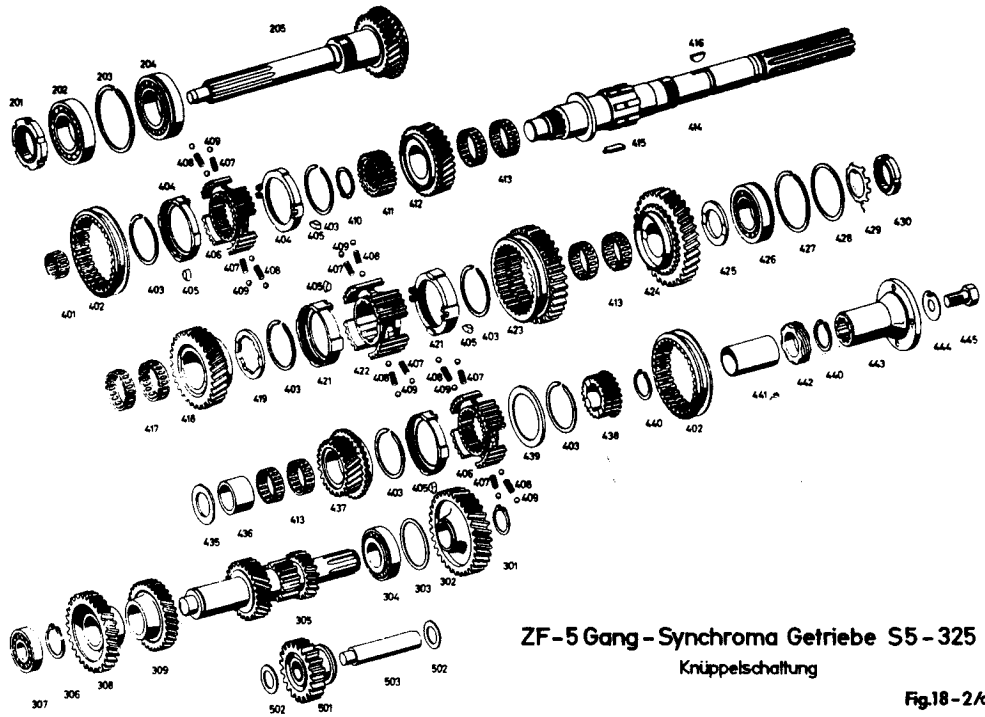
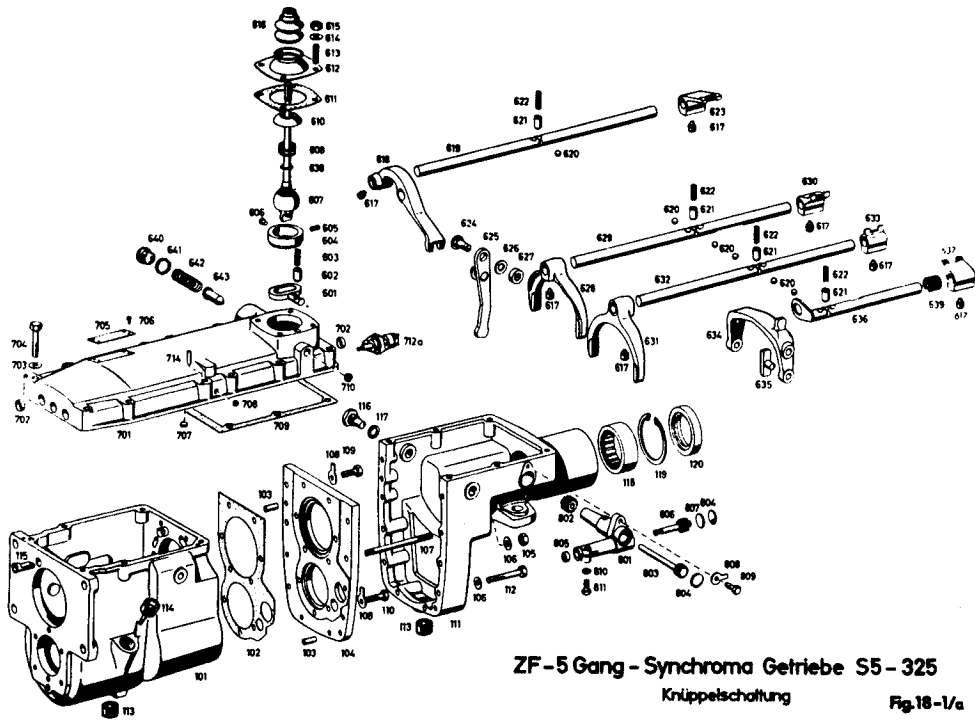

synchronizer body (synchronizer ring facing towards 5th speed gear), using tool .5. (Fig. 30). Projection on sleeve carrier facing towards output side.

Place circlip (440) into radial groove behind the sleeve carrier. Slide distance bush (441) over the main shaft and place 2nd circlip (440) in position. With tool .5., press speedometer worm (442) on the shaft until it rests against the 2nd circlip and secure it with the 3rd circlip.

I. Mount end housing

Press needle bearing (118) into neck of end housing. Place circlip (119) in position and press in shaft seal (120) until it rests against the circlip. (Lip of seal ring towards outside).

Insert one set screw (107) into the thread of the intermediate plate and the other set screw into the long bore of the end housing. Push the end housing over the main shaft and move it about until the set screw sitting in the bore of the end housing

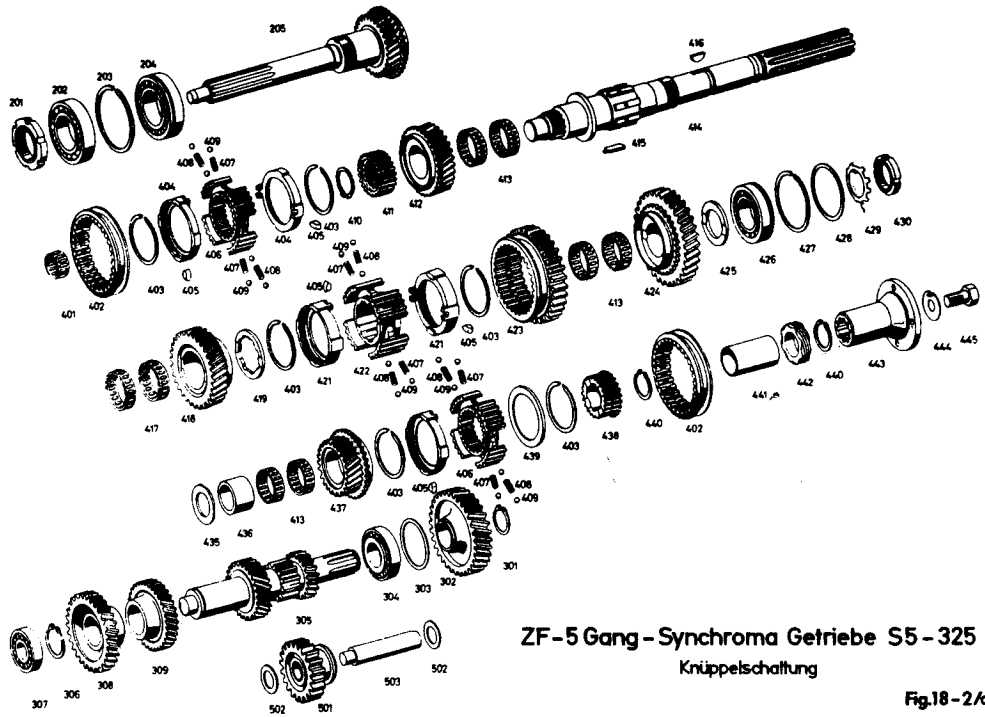
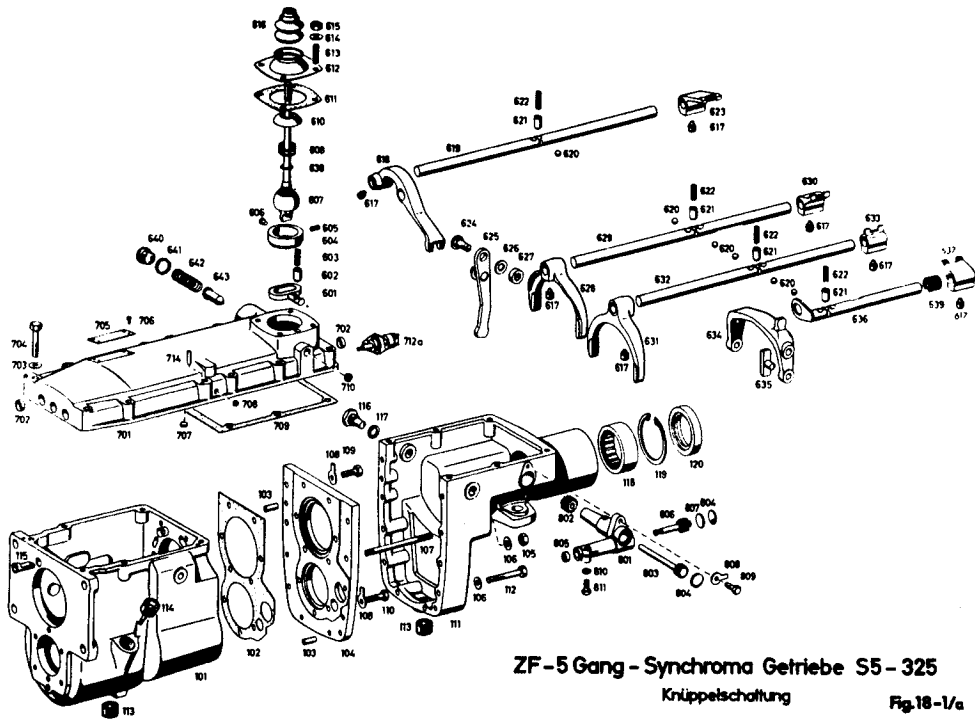

can also be screwed into the thread of the intermediate plate. Secure end housing with screws (109 and 112) and the 2 hexagon nuts (105). Place spring washers (106) below the screws (112) and below the nuts (105). The two screws (109) are secured with tab washers (108). Push output flange (443) on the splined section of the main shaft and secure with hexagon screw (445) and tab washer. Fit speedometer drive and secure with hexagon screw (809) and tab washer (808). Place the two sliding pieces (635) into the bores of the 5th speed selector bracket (634).

Fig. 31.

Guide the pre-assembled selector bracket into the 5th gear sliding sleeve (402) so that the selector finger engages the 5th gear selector bar (Fig. 31) and the swivel bolt (116) with the seal rings (117) can be screwed in. Check selector fork for ease of operation.

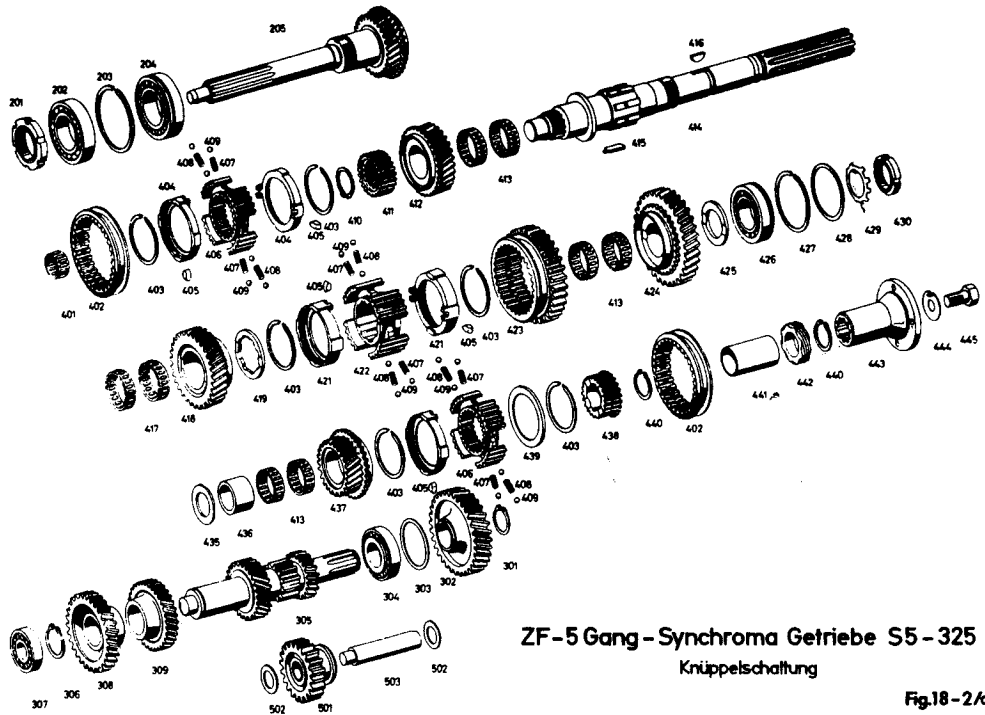
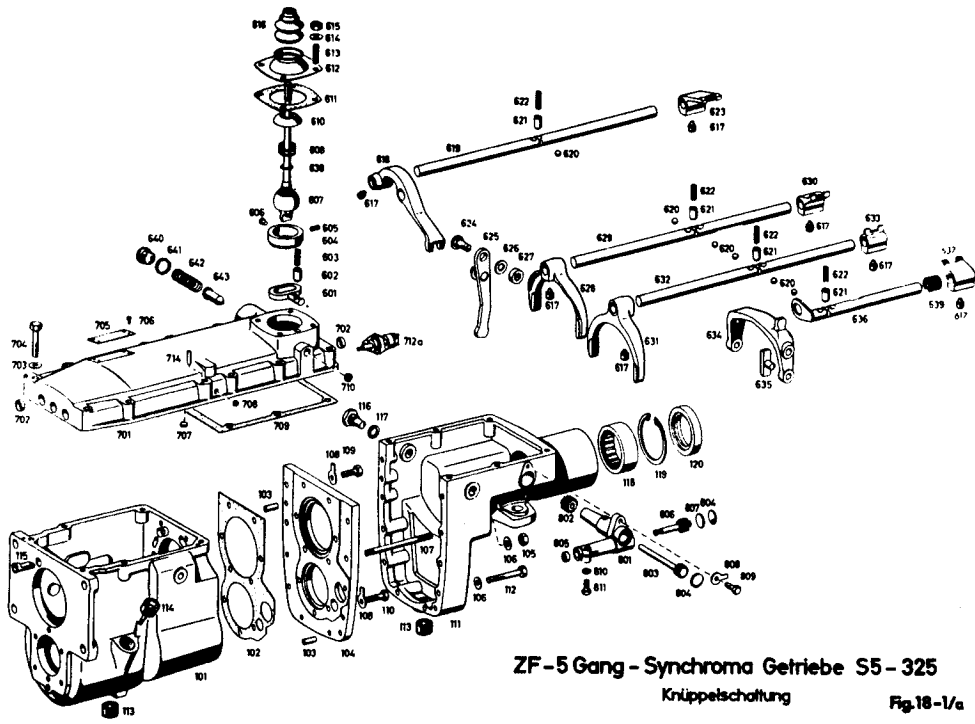

K. Assembly of selector mechanism and housing cover

Place the housing cover (701) on a bench so that the surface which will be joined to the housing faces upwards. Push slide (601), with stop notch upwards, into the transverse bore in the selector tower.

Place 5th speed selector bar (636) (short bar with lug on its end) into the outer bore of the centre cross piece and compression spring (622) and bolt (21) into the bottom bore. Press the selector bar past the detent and push it along until the spring (637a) and the driver (637) can be fitted, screw the grub screw through the driver and into the bore of the selector fork. Put selector bar into neutral. Guide the longest of the 4 selector bars (19) through the bore for the reverse light switch until the reverse gear driver (623) can be fitted before the bar has reached the first cross piece, Push the selector bar up to the centre cross piece, place compression spring (622) and bolt (21) into

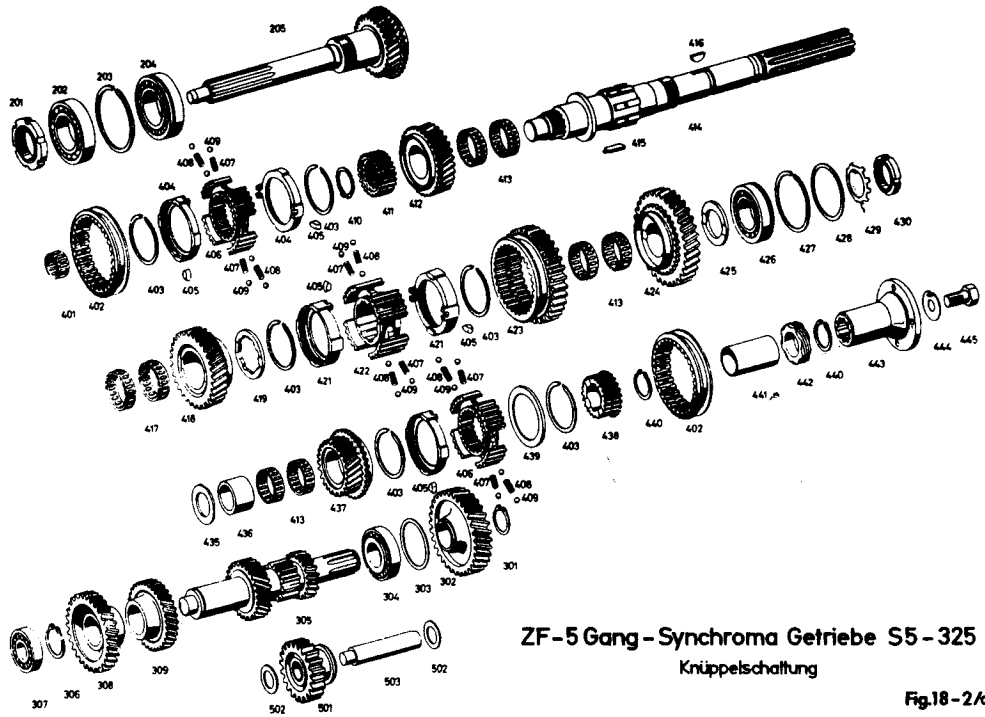
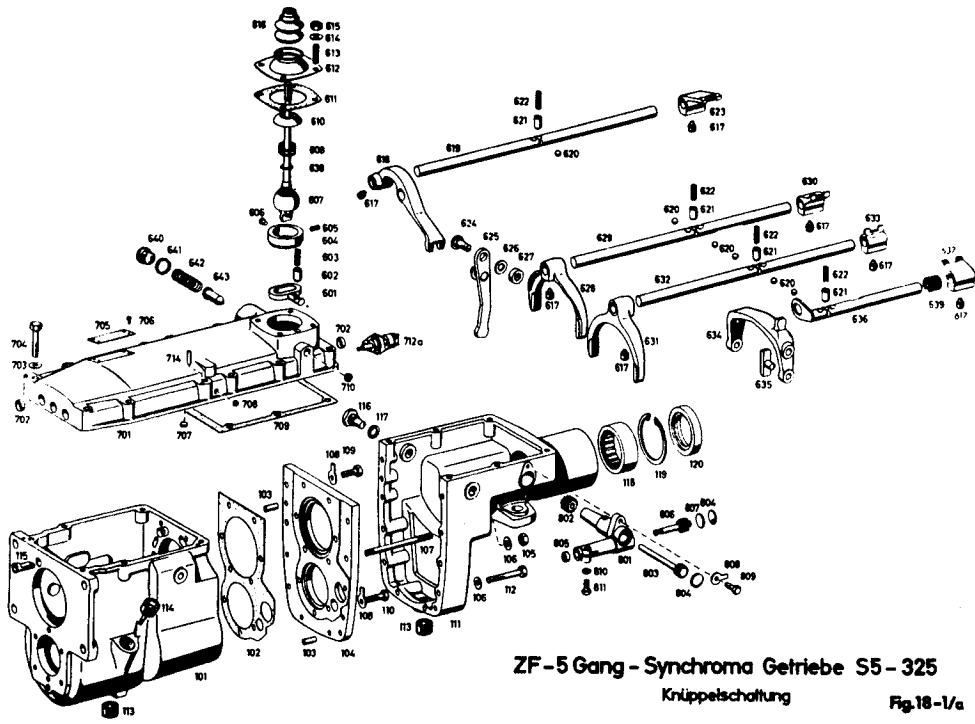

the bottom bore of the centre cross piece and then press the selector bar past the detent. Fit selector fork (618) and push the selector bar through until the bolt can slide into the slot provided for this purpose. Screw grub screw (617) through the driver (623) respectively through the selector fork (618) and into the bores of the selector bar. Put selector bar into neutral. Place two balls into the transverse bore in the centre cross piece between the reverse selector bar and the 1st and 2nd speed selector bar. Guide 1st and 2nd speed selector bar (629) (bar with recess for 5th speed selector bracket) into the bore next to the reverse gear selector bar. Fit driver (630) and place spring (622) and bolt (621) into the bottom bore in the centre cross piece. Push selector bar through and secure selector fork (628) and driver with grub screws. Put selector bar into neutral.

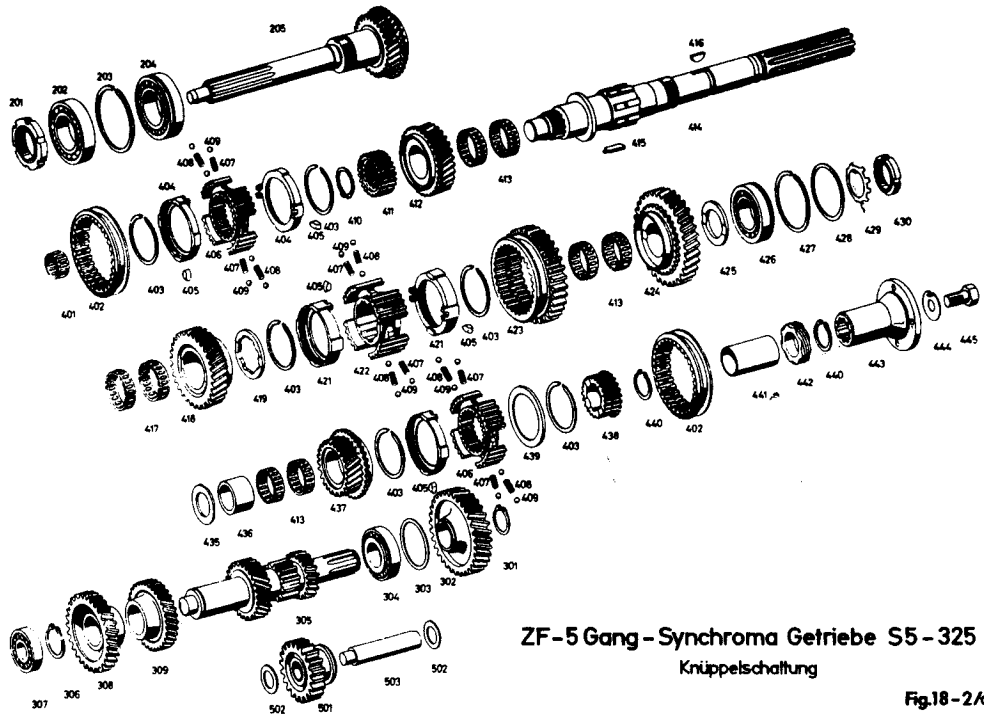
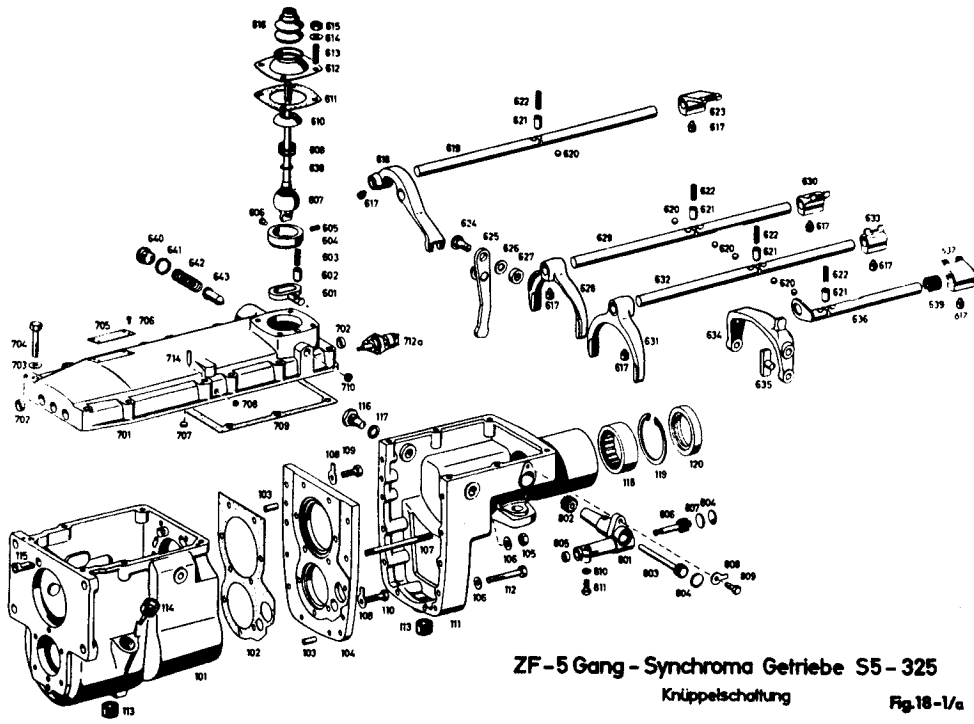

Place two balls into the transverse bore in the centre cross piece between the 5th speed selector bar and the 3rd and 4th speed selector bars.

Place also two balls between 1st and 2nd speed selector bar and 3rd and 4th speed selector bar. Fit 3rd and 4th speed selector bar (632). The 3rd and 4th speed selector bar must be pushed through the bore of the lug on the selector bar (5th speed) and through the reverse selector fork,

Turn the housing cover so that it rests on the selector forks.

Place bolt (606) from the outside into the bore of the ball socket (604).

Place the ball socket into the recess of the cover so that the threaded pin can be screwed through the threaded bore in the cover and into the hollow of the ball socket.

Place the complete gearshift lever (607) into the ball socket.

Fit spring (608), washer (609), rubber gasket () and spring

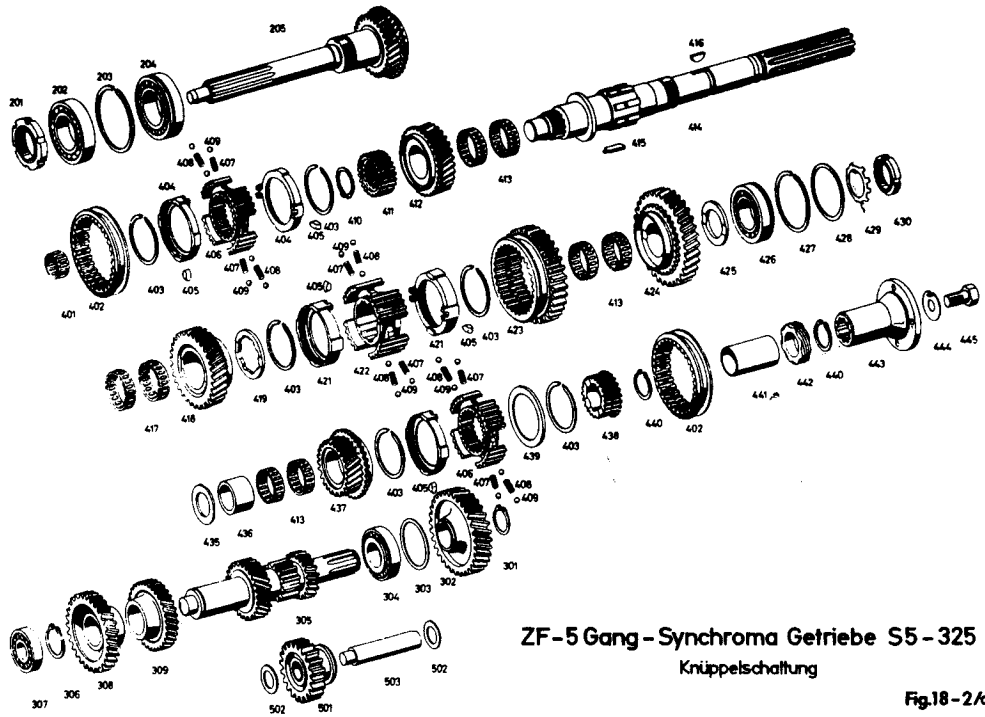
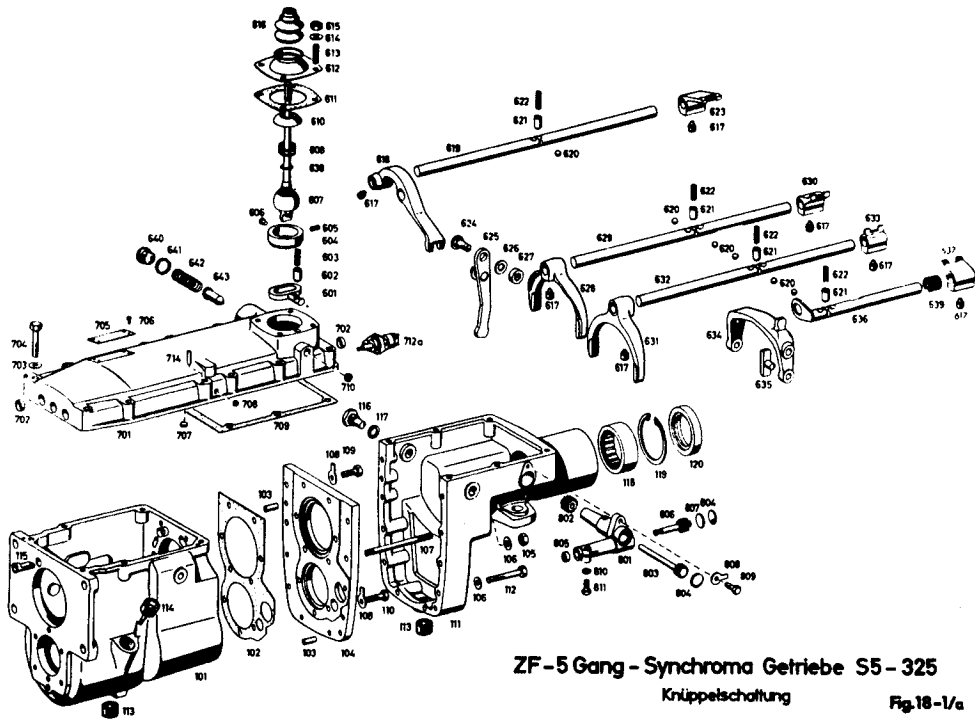

washer (610) to ball end.

Place bolt (602) and spring (603) into the bore of the gearshift cover.

Guide gasket (611) and selector tower (612) over the threaded pins (613) and secure with nuts (615) and spring washers (614). Pull rubber grommet (616) over the selector tower and screw on selector lever knob.

L. Connect pre-assembled housing cover to gearbox housing

Put selector sleeves and reverse gear into neutral.

Make sure that the selector forks are also in neutral.

Place housing cover on gearbox housing, making sure that all selector forks engage with the sliding sleeves and that the fork for reverse engages with the bolt of the 5th speed selector bracket (Fig. 32). Secure cover with screws (704) and spring washers (703).

Fit magnetic plug (113) and oil dip stick (114).

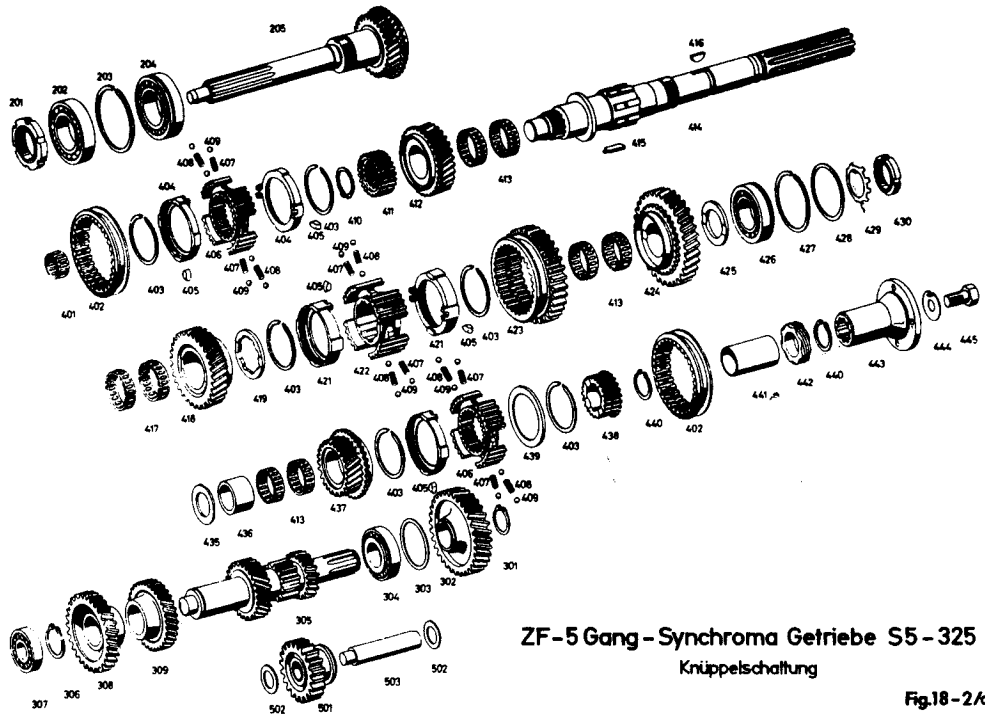
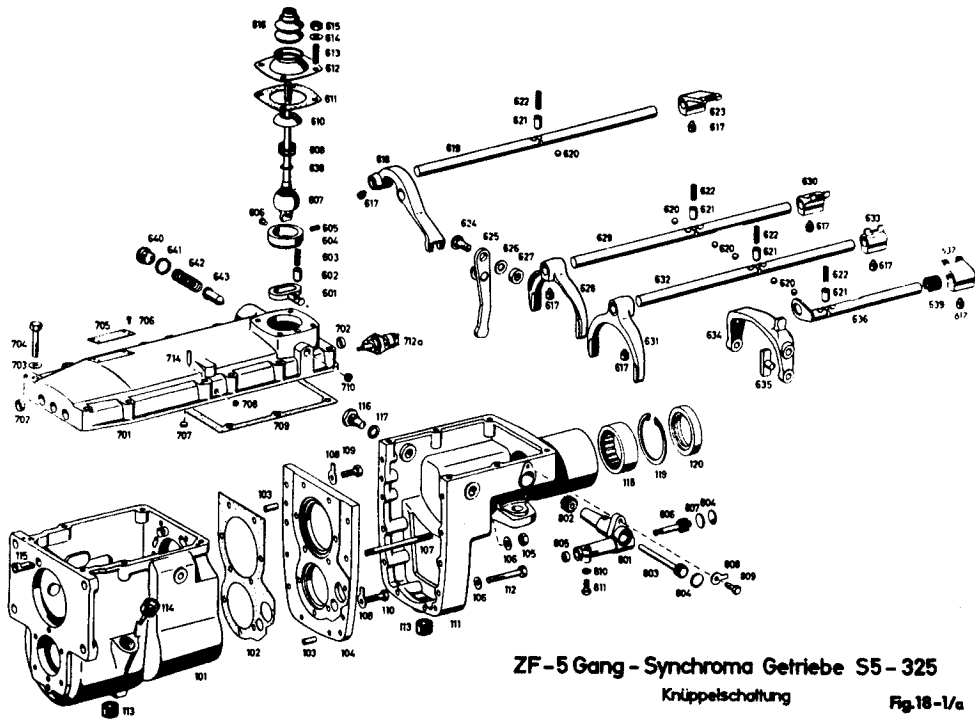

Fig. 32

Operational check

Engage all gears successively. During this procedure turn the input shaft and check that the output flange is carried along in each gear. During the engagement of 1st and 2nd gear and also during the engagement of the 5th gear a detent must be overcome.

For the engagement of the reverse gear the gearshift lever must be lifted upwards.

Checking neutral position of reverse gear:

For this purpose the gearbox must be lifted at the input shaft and the 2nd speed gear must be engaged. Check whether the reverse gear scrapes against the reverse spur gear (423) when the input shaft is turned. If this is the case, nut (627) must be unscrewed and the eccentric pin (624) must be adjusted.

The reverse gear operating lever (625) must be adjusted so that

the reverse gear does not scrape against the reverse spur gear and the gearshift lever does not bind in neutral.

VIII. Order for spare parts

In order to achieve a speedy and correct delivery of spare parts, orders should contain the following details:

1. Gearbox type - S 5-325
2. Gearbox No. - this is stamped on the type plate on the gearbox housing cover
3. Designation of required spare parts: Name the spare part exactly as given in the spare parts list and instruction manual
4. Part No. This is the 10 digit number stamped on or cast in the spare part to be replaced
- 5, If one or several indications of point 1 - 4 cannot be given the following details are important:
 - a) Reference No. given in the instruction manual

b) Make and type of vehicle and name of firm, which manufactured the chassis.

6. Method of dispatch: by post, freight, express, etc., otherwise the method of dispatch will be left to our discretion.

A clearly expressed order is as follows:

I hereby order for gearbox S 5-325, gearbox No. 135

1 complete input shaft 1248 202 900

consisting of:

complete input shaft 1248 202 006

clutch body 1248 302 007

Dispatch immediately by express.

Orders made by telephone or telegraph must be confirmed in writing. Dispatch is made at Purchaser's risk, even if no charge is made for the spare parts. Spare parts are only supplied free of charge during the guarantee period, provided that on examining the part, it is found that the damage was due to faulty manufacture or

defective material. For this reason the faulty part must be returned to us for testing without having been tampered with and all carriage paid. Faulty samples will be scrapped unless their return is especially requested when they are sent to us.

Terms of payment: Cash on delivery.

Die Teile 711 und 712 für Getriebe ohne Rückfahrlichtschalter
 Teil 712a für Getriebe mit Rückfahrlichtschalter
 Parts 711 and 712 for transmissions without back lights' switch
 Part 712a for transmissions with back lights' switch

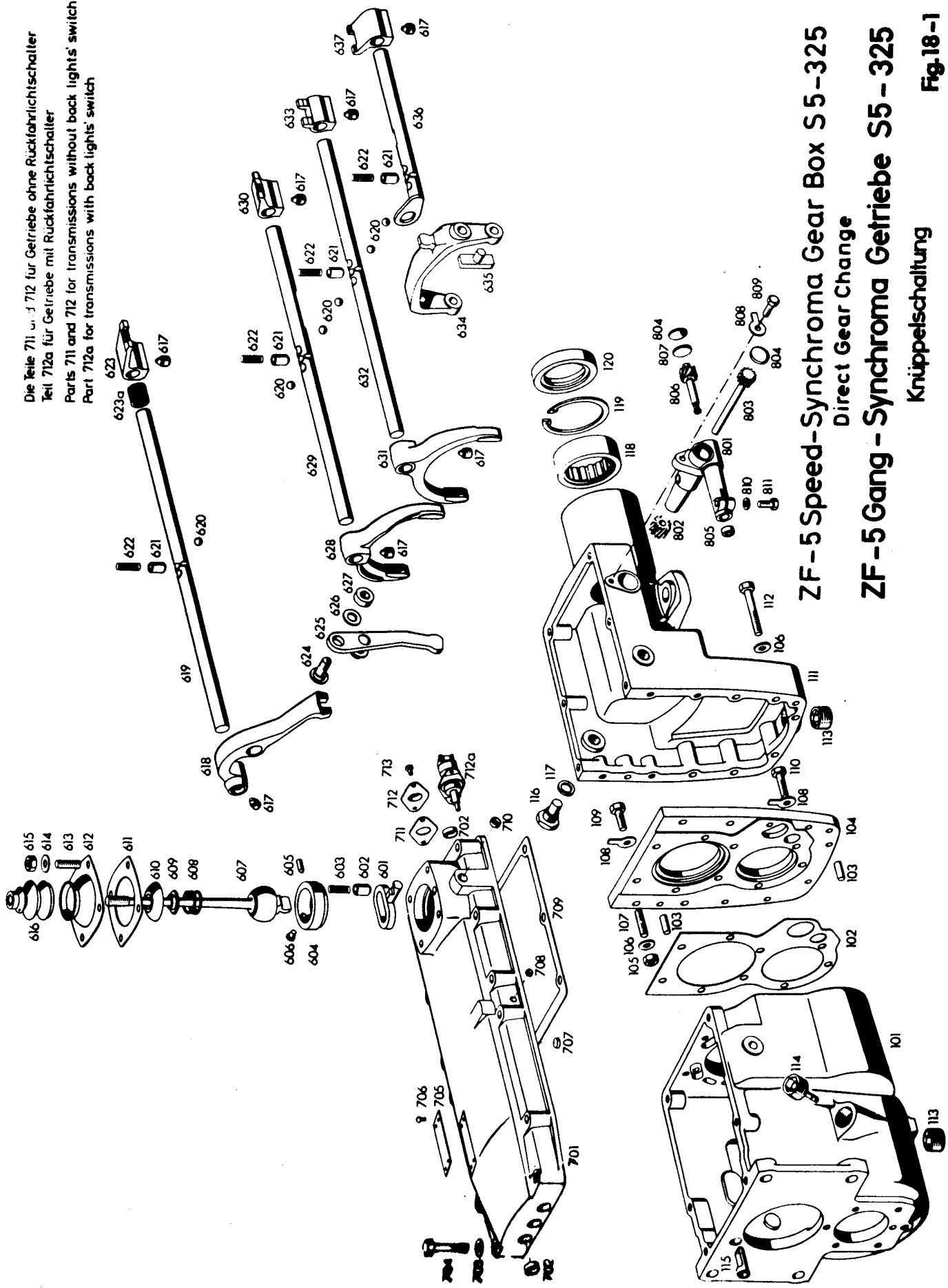

ZF-5 Speed-Synchroma Gear Box S5-325
 Direct Gear Change
 ZF-5 Gang - Synchroma Getriebe S5-325
 Knüppelschaltung

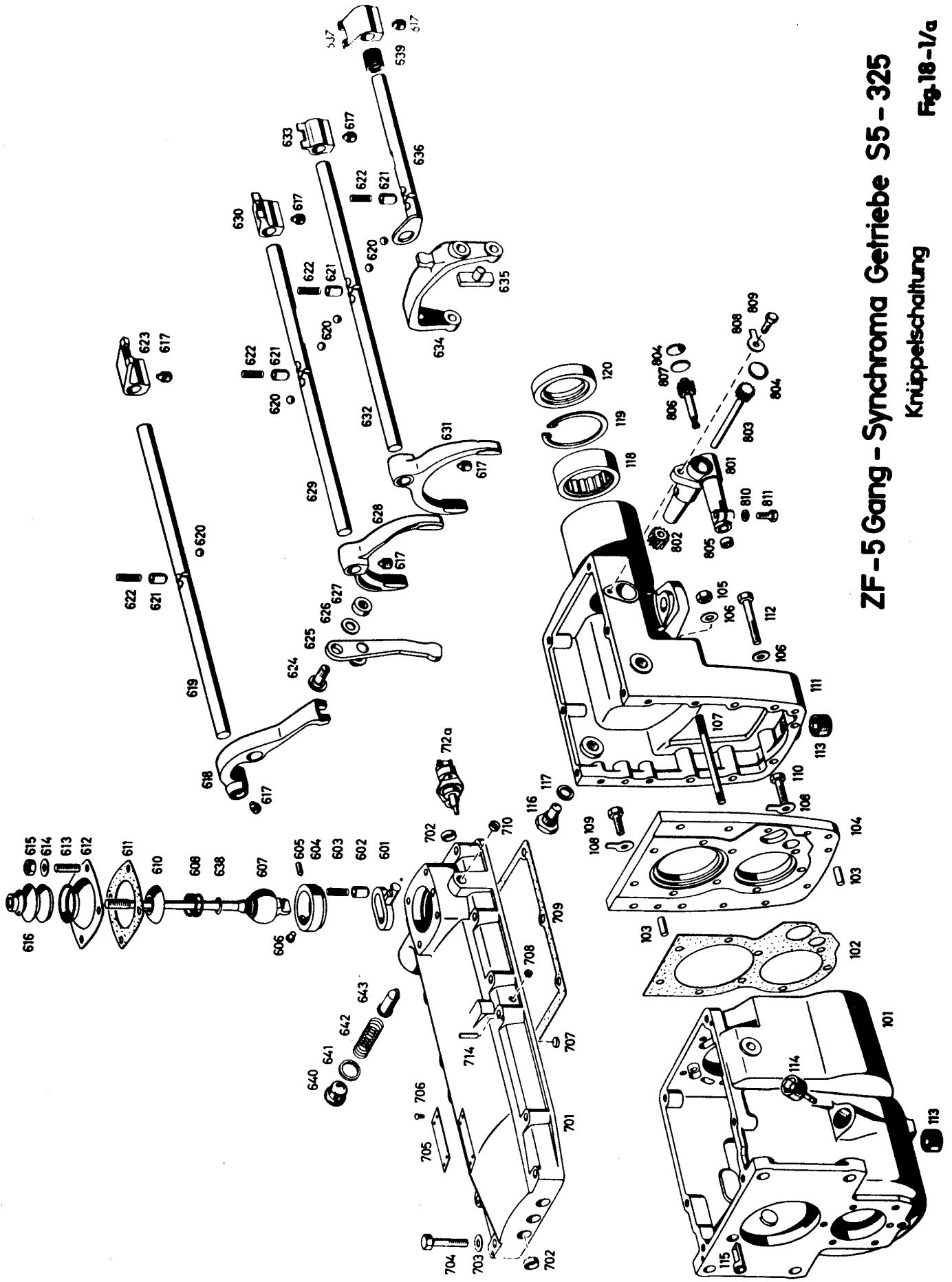

ZF-5 Gang - Synchroma Getriebe S5 - 325

Kruppelschaltung

Fig.18-1/a

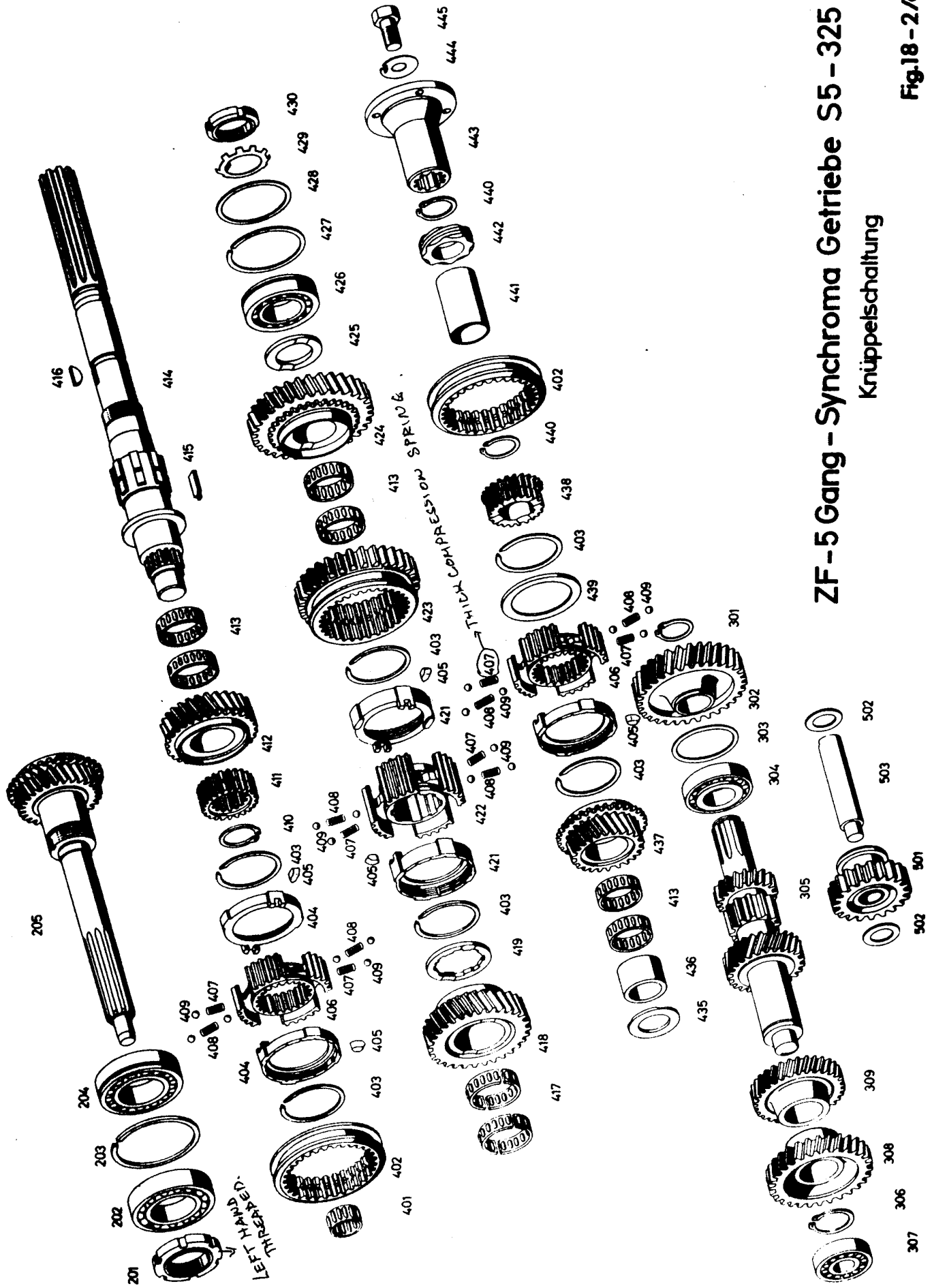

ZF-5 Gang - Synchroma Getriebe S5 - 325

Kniuppelschaltung

Fig.18 - 2/a

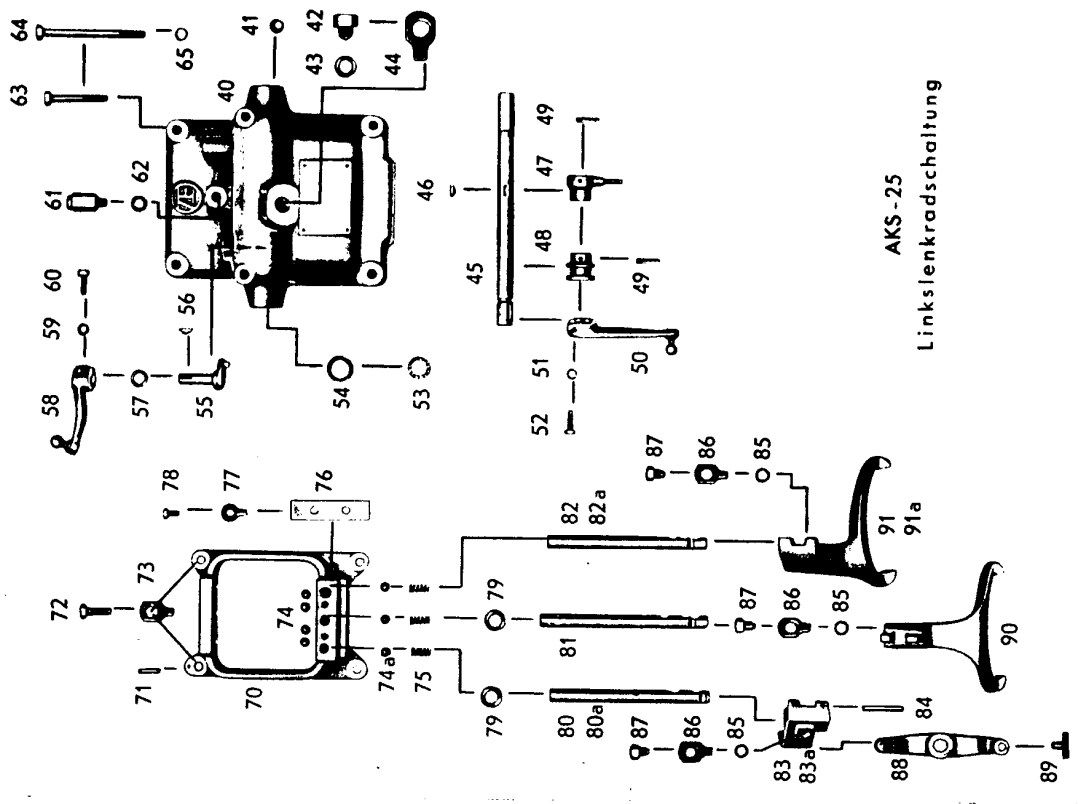

AKS-25
Linkslenkradschaltung

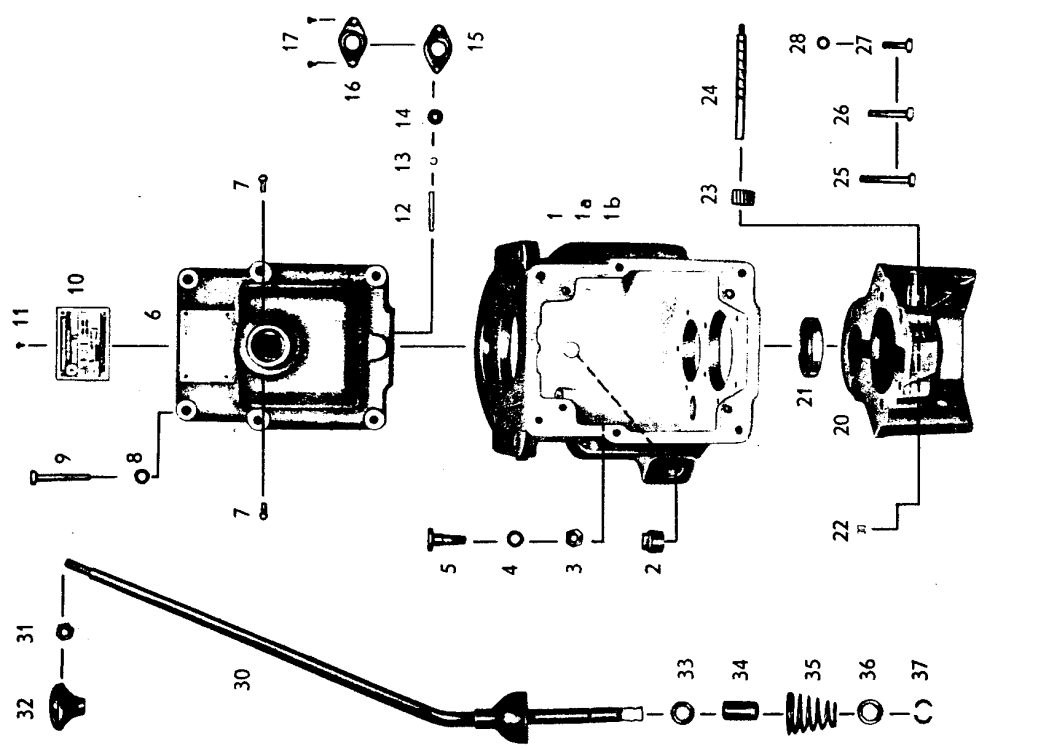

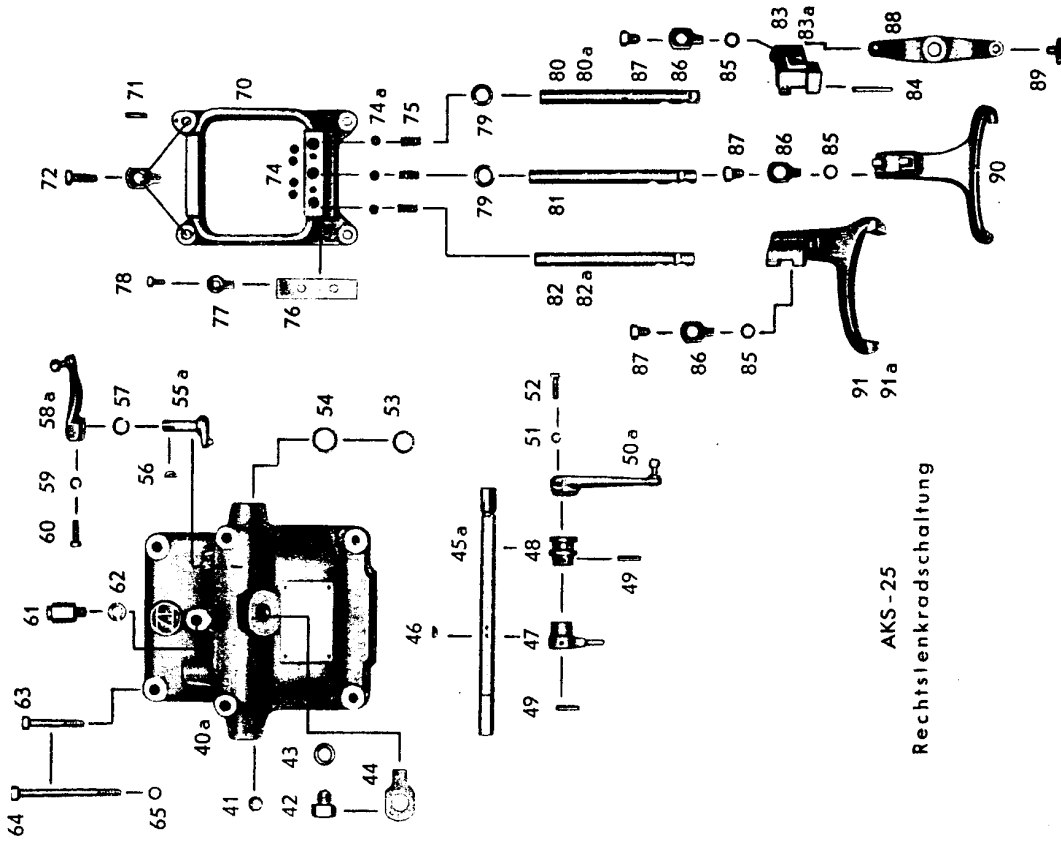
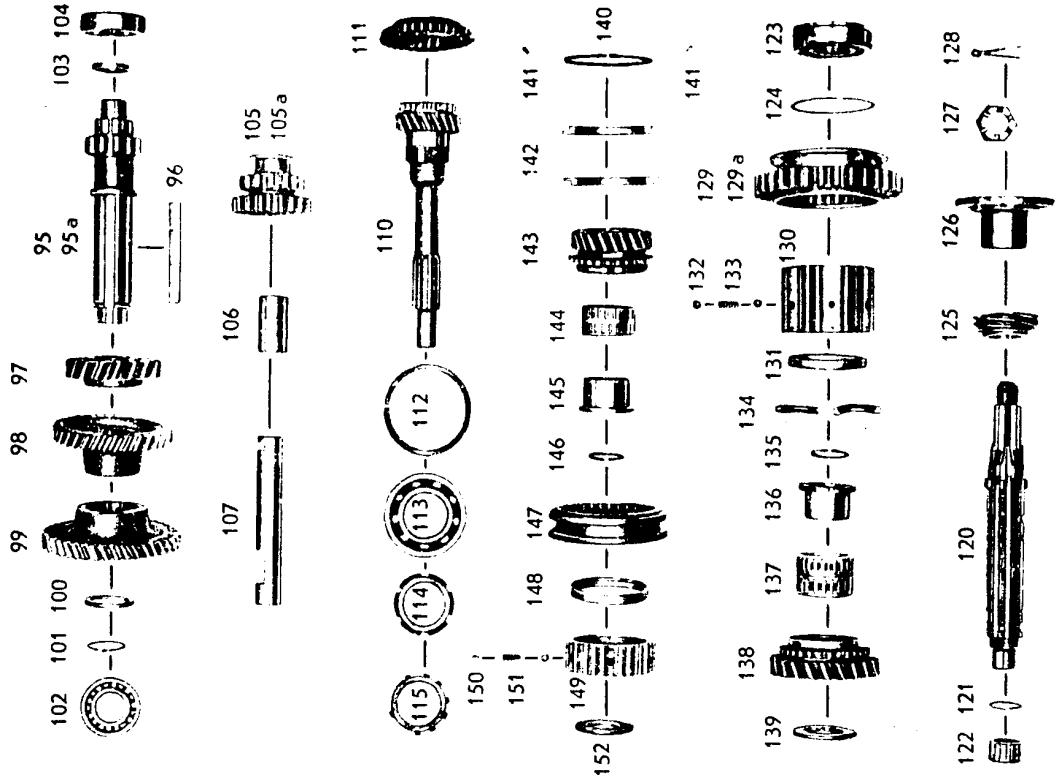

AKS-25
Rechtslenkradschaltung